

# PARTS LIST

## ■ ELECTRICAL PARTS

### ■ WARNING

Components having special characteristics are marked  $\triangle$  and must be replaced with parts having specifications equal to those originally installed.

- Carbon resistors (1/6W or 1/4W) are not included in the ELECTRICAL PARTS List. For the parts No. of the carbon resistors, refer to last page.
- Chip resistors are listed on page 99.

### ABBREVIATIONS IN THIS LIST ARE AS FOLLOWS :

C.A.EL.CHP	: CHIP ALUMI. ELECTROLYTIC CAP	L.EMIT	: LIGHT EMITTING MODULE
C.CE	: CERAMIC CAP	LED.DSPLY	: LED DISPLAY
C.CE.ARRAY	: CERAMIC CAP ARRAY	LED.INFRD	: LED, INFRARED
C.CE.CHP	: CHIP CERAMIC CAP	MODUL.RF	: MODULATOR, RF
C.CE.ML	: MULTILAYER CERAMIC CAP	PHOT.CPL	: PHOTO COUPLER
C.CE.M.CHP	: CHIP MULTILAYER CERAMIC CAP	PHOT.INTR	: PHOTO INTERRUPTER
C.CE.SAFTY	: RECOGNIZED CERAMIC CAP	PHOT.RFLCT	: PHOTO REFLECTOR
C.CE.TUBLR	: CERAMIC TUBULAR CAP	PIN.TEST	: PIN, TEST POINT
C.CE.SMI	: SEMI CONDUCTIVE CERAMIC CAP	PLST.RIVET	: PLASTIC RIVET
C.EL	: ELECTROLYTIC CAP	R.ARRAY	: RESISTOR ARRAY
C.MICA	: MICA CAP	R.CAR	: CARBON RESISTOR
C.ML.FLM	: MULTILAYER FILM CAP	R.CAR.CHP	: CHIP RESISTOR
C.MP	: METALLIZED PAPER CAP	R.CAR.FP	: FLAME PROOF CARBON RESISTOR
C.MYLAR	: MYLAR FILM CAP	R.FUS	: FUSABLE RESISTOR
C.MYLAR.ML	: MULTILAYER MYLAR FILM CAP	R.MTL.CHP	: CHIP METAL FILM RESISTOR
C.PAPER	: PAPER CAPACITOR	R.MTL.FLM	: METAL FILM RESISTOR
C.PLS	: POLYSTYRENE FILM CAP	R.MTL.OXD	: METAL OXIDE FILM RESISTOR
C.POL	: POLYESTER FILM CAP	R.MTL.PLAT	: METAL PLATE RESISTOR
C.POLY	: POLYETHYLENE FILM CAP	RSNR.CE	: CERAMIC RESONATOR
C.PP	: POLYPROPYLENE FILM CAP	RSNR.CRYS	: CRYSTAL RESONATOR
C.TNTL	: TANTALUM CAP	R.TW.CEM	: TWIN CEMENT FIXED RESISTOR
C.TNTL.CHP	: CHIP TANTALUM CAP	R.WW	: WIRE WOUND RESISTOR
C.TRIM	: TRIMMER CAP	SCR.BND.HD	: BIND HEAD B-TITE SCREW
CN	: CONNECTOR	SCR.BW.HD	: BW HEAD TAPPING SCREW
CN.BS.PIN	: CONNECTOR, BASE PIN	SCR.CUP	: CUP TITE SCREW
CN.CANNON	: CONNECTOR, CANNON	SCR.TERM	: SCREW TERMINAL
CN.DIN	: CONNECTOR, DIN	SCR.TR	: SCREW, TRANSISTOR
CN.FLAT	: CONNECTOR, FLAT CABLE	SUPRT.PCB	: SUPPORT, P.C.B.
CN.POST	: CONNECTOR, BASE POST	SURG.PRTCT	: SURGE PROTECTOR
COIL.MX.AM	: COIL, AM MIX	SW.TACT	: TACT SWITCH
COIL.AT.FM	: COIL, FM ANTENNA	SW.LEAF	: LEAF SWITCH
COIL.DT.FM	: COIL, FM DETECT	SW.LEVER	: LEVER SWITCH
COIL.MX.FM	: COIL, FM MIX	SW.MICRO	: MICRO SWITCH
COIL.OUTPT	: OUTPUT COIL	SW.PUSH	: PUSH SWITCH
DIOD.ARRAY	: DIODE ARRAY	SW.RT.ENC	: ROTARY ENCODER
DIODE.BRG	: DIODE BRIDGE	SW.RT.MTR	: ROTARY SWITCH WITH MOTOR
DIODE.CHP	: CHIP DIODE	SW.RT	: ROTARY SWITCH
DIODE.VAR	: VARACTOR DIODE	SW.SLIDE	: SLIDE SWITCH
DIOD.Z.CHP	: CHIP ZENER DIODE	TERM.SP	: SPEAKER TERMINAL
DIODE.ZENR	: ZENER DIODE	TERM.WRAP	: WRAPPING TERMINAL
DSCR.CE	: CERAMIC DISCRIMINATOR	THRMST.CHP	: CHIP THERMISTOR
FER.BEAD	: FERRITE BEADS	TR.CHP	: CHIP TRANSISTOR
FER.CORE	: FERRITE CORE	TR.DGT	: DIGITAL TRANSISTOR
FET.CHP	: CHIP FET	TR.DGT.CHP	: CHIP DIGITAL TRANSISTOR
FL.DSPLY	: FLUORESCENT DISPLAY	TRANS	: TRANSFORMER
FLTR.CE	: CERAMIC FILTER	TRANS.PULS	: PULSE TRANSFORMER
FLTR.COMB	: COMB FILTER MODULE	TRANS.PWR	: POWER TRANSFORMER ASS'y
FLTR.LC.RF	: LC FILTER, EMI	TUNER.AM	: TUNER PACK, AM
GND.MTL	: GROUND PLATE	TUNER.FM	: TUNER PACK, FM
GND.TERM	: GROUND TERMINAL	TUNER.PK	: FRONT-END TUNER PACK
HOLDER.FUS	: FUSE HOLDER	VR	: ROTARY POTENTIOMETER
IC.PRTCT	: IC PROTECTOR	VR.MTR	: POTENTIOMETER WITH MOTOR
JUMPER.CN	: JUMPER CONNECTOR	VR.SW	: POTENTIOMETER WITH ROTARY SW
JUMPER.TST	: JUMPER, TEST POINT	VR.SLIDE	: SLIDE POTENTIOMETER
L.DTCT	: LIGHT DETECTING MODULE	VR.TRIM	: TRIMMER POTENTIOMETER

**Note)** Those parts marked with “#” are not included in the P.C.B. ass'y.

P.C.B. DSP

Schm Ref.	PART NO.	Description		
*	V6600000	P.C.B.	DSP (UC)	
*	V6600100	P.C.B.	DSP (RLT)	
*	V6600200	P.C.B.	DSP (ABG)	
CB501	V6022800	CN.FBRLINK	1P GP1FA551TZ	
CB502	V6022800	CN.FBRLINK	1P GP1FA551TZ	
CB503	V5478200	CN.PHOT.SN	1P GP1FA551RZ	
CB504	V5478200	CN.PHOT.SN	1P GP1FA551RZ	
CB505	V5478200	CN.PHOT.SN	1P GP1FA551RZ	
CB506	V5478200	CN.PHOT.SN	1P GP1FA551RZ	
CB507	V5478200	CN.PHOT.SN	1P GP1FA551RZ	
* CB508	VQ045800	CN.BS.PIN	29P SE	
C501	US135100	C.CE.CHP	0.1uF	16V
C502	US135100	C.CE.CHP	0.1uF	16V
C503	US135100	C.CE.CHP	0.1uF	16V
C504	US135100	C.CE.CHP	0.1uF	16V
C505	US135100	C.CE.CHP	0.1uF	16V
C506	US135100	C.CE.CHP	0.1uF	16V
C507	US135100	C.CE.CHP	0.1uF	16V
C508	US135100	C.CE.CHP	0.1uF	16V
C509	UU147220	C.EL	22uF	25V
C510	US061220	C.CE.M.CHP	22pF	50V
C511	US135100	C.CE.CHP	0.1uF	16V
C512	UU147220	C.EL	22uF	25V
C513	US061220	C.CE.M.CHP	22pF	50V
C514	US135100	C.CE.CHP	0.1uF	16V(RLT)
C515	UU147220	C.EL	22uF	25V(RLT)
C517	US061100	C.CE.M.CHP	10pF	50V(RLT)
C518	US044220	C.CE.M.CHP	0.022uF	25V(RLT)
C519	US044220	C.CE.M.CHP	0.022uF	25V(RLT)
C520	US135100	C.CE.CHP	0.1uF	16V
C521	UU147100	C.EL	10uF	25V
C522	US135100	C.CE.CHP	0.1uF	16V
C523	US061100	C.CE.M.CHP	10pF	50V
C524	US061100	C.CE.M.CHP	10pF	50V
C525	US061100	C.CE.M.CHP	10pF	50V(RLT)
C526	US044220	C.CE.M.CHP	0.022uF	25V(RLT)
* C527	US061750	C.CE.CHP	75pF	50V(RLT)
C528	US135100	C.CE.CHP	0.1uF	16V
C529	US061100	C.CE.M.CHP	10pF	50V
C530	US044220	C.CE.M.CHP	0.022uF	25V
C531	US061330	C.CE.M.CHP	33pF	50V
C532	US063100	C.CE.M.CHP	1000pF	50V
C533	US062220	C.CE.CHP	220pF	50V
C534	US063100	C.CE.M.CHP	1000pF	50V
C535	US062220	C.CE.CHP	220pF	50V
C536	US063100	C.CE.M.CHP	1000pF	50V
C537	US062220	C.CE.CHP	220pF	50V(RLT)
C538	US063100	C.CE.M.CHP	1000pF	50V(RLT)
C539	US061100	C.CE.M.CHP	10pF	50V(RLT)
C540	UU137470	C.EL	47uF	16V(RLT)
C541	US135100	C.CE.CHP	0.1uF	16V(RLT)
C542	UU137470	C.EL	47uF	16V(RLT)
C543	US135100	C.CE.CHP	0.1uF	16V(RLT)

\* New Parts

Schm Ref.	PART NO.	Description		
C544	US135100	C.CE.CHP	0.1uF	16V
C545	US135100	C.CE.CHP	0.1uF	16V
C546	UU128100	C.EL	100uF	10V
C547	UU128100	C.EL	100uF	10V
C548	US135100	C.CE.CHP	0.1uF	16V
C549	US135100	C.CE.CHP	0.1uF	16V
C550	US135100	C.CE.CHP	0.1uF	16V
C551	US135100	C.CE.CHP	0.1uF	16V
C552	US135100	C.CE.CHP	0.1uF	16V
C553	US135100	C.CE.CHP	0.1uF	16V
C554	US064100	C.CE.M.CHP	0.01uF	50V(RLT)
C555	VR169200	C.MYLAR.ML	ECQ-V1H474JL3(RLT)	
C556	US135100	C.CE.CHP	0.1uF	16V
C557	UU128100	C.EL	100uF	10V
C558	UU128100	C.EL	100uF	10V
C559	US135100	C.CE.CHP	0.1uF	16V
C560	UU128100	C.EL	100uF	10V
C561	UU128100	C.EL	100uF	10V
C562	US135100	C.CE.CHP	0.1uF	16V
C563	US135100	C.CE.CHP	0.1uF	16V
C564	US061330	C.CE.M.CHP	33pF	50V
C565	US061330	C.CE.M.CHP	33pF	50V
C566	UU137470	C.EL	47uF	16V
C567	US135100	C.CE.CHP	0.1uF	16V(RLT)
C568	US135100	C.CE.CHP	0.1uF	16V(RLT)
C569	US135100	C.CE.CHP	0.1uF	16V(RLT)
C570	US135100	C.CE.CHP	0.1uF	16V(RLT)
C571	US135100	C.CE.CHP	0.1uF	16V(RLT)
C572	UU128100	C.EL	100uF	10V(RLT)
C573	UU128100	C.EL	100uF	10V(RLT)
C574	VR169200	C.MYLAR.ML	ECQ-V1H474JL3(RLT)	
C575	US135100	C.CE.CHP	0.1uF	16V
C576	UU128100	C.EL	100uF	10V
C577	US061470	C.CE.M.CHP	47pF	50V
C578	US061470	C.CE.M.CHP	47pF	50V
C579	US061470	C.CE.M.CHP	47pF	50V
C580	US061470	C.CE.M.CHP	47pF	50V
C581	US061470	C.CE.M.CHP	47pF	50V
C582	US061470	C.CE.M.CHP	47pF	50V
C583	US061470	C.CE.M.CHP	47pF	50V
C584	UU128100	C.EL	100uF	10V
C585	US135100	C.CE.CHP	0.1uF	16V
C587	US135100	C.CE.CHP	0.1uF	16V
C588	US063470	C.CE.CHP	4700pF	50V
C589	UU128100	C.EL	100uF	10V
C590	UN837470	C.EL	47uF	16V(RLT)
C591	US135100	C.CE.CHP	0.1uF	16V(RLT)
C592	UU128100	C.EL	100uF	10V(RLT)
C593	US135100	C.CE.CHP	0.1uF	16V(RLTABG)
C594	US135100	C.CE.CHP	0.1uF	16V
C595	US135100	C.CE.CHP	0.1uF	16V
C596	US135100	C.CE.CHP	0.1uF	16V
C597	US135100	C.CE.CHP	0.1uF	16V

\* New Parts

## P.C.B. DSP

Schm Ref.	PART NO.	Description		
C598	US061470	C. CE .M. CHP	47pF	50V
C599	US135100	C. CE .CHP	0.1uF	16V
C600	US135100	C. CE .CHP	0.1uF	16V
C601	US135100	C. CE .CHP	0.1uF	16V(RLT)
C602	US064100	C. CE .M. CHP	0.01uF	50V(RLT)
C603	US061180	C. CE .CHP	18pF	50V(RLT)
* C604	US060200	C. CE .CHP	2pF	50V(RLT)
C605	US135100	C. CE .CHP	0.1uF	16V
C606	UU128100	C. EL	100uF	10V
C607	US135100	C. CE .CHP	0.1uF	16V
C608	US135100	C. CE .CHP	0.1uF	16V
C609	US135100	C. CE .CHP	0.1uF	16V
C610	UU128100	C. EL	100uF	10V
C611	UU128100	C. EL	100uF	10V(RLT)
C612	US064100	C. CE .M. CHP	0.01uF	50V(RLT)
C613	US135100	C. CE .CHP	0.1uF	16V(RLT)
C614	UU128100	C. EL	100uF	10V(RLT)
C615	US135100	C. CE .CHP	0.1uF	16V
C616	UU137470	C. EL	47uF	16V
C619	US135100	C. CE .CHP	0.1uF	16V
C620	UU128100	C. EL	100uF	10V
C621	UU137470	C. EL	47uF	16V
C622	US135100	C. CE .CHP	0.1uF	16V
C623	US135100	C. CE .CHP	0.1uF	16V
C624	UU137470	C. EL	47uF	16V
C625	UU137470	C. EL	47uF	16V
C626	US135100	C. CE .CHP	0.1uF	16V
C627	US135100	C. CE .CHP	0.1uF	16V
C628	UU137470	C. EL	47uF	16V
C629	UU137470	C. EL	47uF	16V
C630	US135100	C. CE .CHP	0.1uF	16V
C631	US135100	C. CE .CHP	0.1uF	16V
C632	US135100	C. CE .CHP	0.1uF	16V
C633	UU137470	C. EL	47uF	16V
C634	UU137470	C. EL	47uF	16V
C635	US135100	C. CE .CHP	0.1uF	16V
C636	US135100	C. CE .CHP	0.1uF	16V
C637	UU166220	C. EL	2.2uF	50V
C638	US135100	C. CE .CHP	0.1uF	16V
C639	UU128100	C. EL	100uF	10V
C640	US135100	C. CE .CHP	0.1uF	16V
C641	UU128100	C. EL	100uF	10V
C642	UU137220	C. EL	22uF	16V
C643	UU137220	C. EL	22uF	16V
C644	UU137220	C. EL	22uF	16V
C645	US135100	C. CE .CHP	0.1uF	16V
C646	UU128100	C. EL	100uF	10V
C647	US135100	C. CE .CHP	0.1uF	16V
C648	UU128100	C. EL	100uF	10V
C649	UU137220	C. EL	22uF	16V
C650	UU137220	C. EL	22uF	16V
C651	UU137220	C. EL	22uF	16V
C652	US135100	C. CE .CHP	0.1uF	16V

\* New Parts

Schm Ref.	PART NO.	Description		
C653	UU128100	C. EL	100uF	10V
C654	UU137220	C. EL	22uF	16V
C655	UU137220	C. EL	22uF	16V
C656	UU137220	C. EL	22uF	16V
C657	US135100	C. CE .CHP	0.1uF	16V
C658	UU128100	C. EL	100uF	10V
C659	UU128100	C. EL	100uF	10V
C660	US061470	C. CE .M. CHP	47pF	50V
C661	US061470	C. CE .M. CHP	47pF	50V
C662	US061470	C. CE .M. CHP	47pF	50V
C663	US061470	C. CE .M. CHP	47pF	50V
C664	US061470	C. CE .M. CHP	47pF	50V
C665	US061470	C. CE .M. CHP	47pF	50V
C666	UA652100	C. MYLAR	100pF	50V
C667	UA653330	C. MYLAR	3300pF	50V
C668	US135100	C. CE .CHP	0.1uF	16V
C670	UA653330	C. MYLAR	3300pF	50V
C671	UA652100	C. MYLAR	100pF	50V
C672	UA652100	C. MYLAR	100pF	50V
C673	UA653330	C. MYLAR	3300pF	50V
C674	US135100	C. CE .CHP	0.1uF	16V
C675	UA653150	C. MYLAR	1500pF	50V
C676	UA653150	C. MYLAR	1500pF	50V
C677	UU147100	C. EL	10uF	25V
C678	US135100	C. CE .CHP	0.1uF	16V
C679	US135100	C. CE .CHP	0.1uF	16V
C680	UU147100	C. EL	10uF	25V
C681	UU147100	C. EL	10uF	25V
C682	US135100	C. CE .CHP	0.1uF	16V
C683	US135100	C. CE .CHP	0.1uF	16V
C684	UU147100	C. EL	10uF	25V
C685	UU147100	C. EL	10uF	25V
C686	US135100	C. CE .CHP	0.1uF	16V
C687	US135100	C. CE .CHP	0.1uF	16V
C688	UU147100	C. EL	10uF	25V
C689	UA653820	C. MYLAR	8200pF	50V
C690	Vi715100	C. MYLAR	470pF	50V
C691	Vi715100	C. MYLAR	470pF	50V
C692	UA653820	C. MYLAR	8200pF	50V
C693	UA653820	C. MYLAR	8200pF	50V
C694	Vi715100	C. MYLAR	470pF	50V
C695	UA652100	C. MYLAR	100pF	50V
C696	UA652100	C. MYLAR	100pF	50V
C697	UA652100	C. MYLAR	100pF	50V
C698	UA652100	C. MYLAR	100pF	50V
C699	UU147100	C. EL	10uF	25V
C700	UU147100	C. EL	10uF	25V
C701	Vi715100	C. MYLAR	470pF	50V
C702	Vi715100	C. MYLAR	470pF	50V
C703	UU147100	C. EL	10uF	25V
C704	UU147100	C. EL	10uF	25V
C705	UU147100	C. EL	10uF	25V
C706	UU147100	C. EL	10uF	25V

\* New Parts

## P.C.B. DSP

Schm Ref.	PART NO.	Description		
C707	Vi715100	C.MYLAR	470pF	50V
C708	Vi715100	C.MYLAR	470pF	50V
C709	UU147100	C.EL	10uF	25V
C710	UU147100	C.EL	10uF	25V
C711	UU147100	C.EL	10uF	25V
C712	UU147100	C.EL	10uF	25V
C713	Vi715100	C.MYLAR	470pF	50V
C714	Vi715100	C.MYLAR	470pF	50V
C715	UU147100	C.EL	10uF	25V
C716	UU147100	C.EL	10uF	25V
C717	US135100	C.CE.CHP	0.1uF	16V
C718	US061470	C.CE.M.CHP	47pF	50V
C719	US061470	C.CE.M.CHP	47pF	50V
C720	US061470	C.CE.M.CHP	47pF	50V
C721	US061470	C.CE.M.CHP	47pF	50V
C722	US061470	C.CE.M.CHP	47pF	50V
C723	UU147100	C.EL	10uF	25V
C724	UU147100	C.EL	10uF	25V
C725	UU147100	C.EL	10uF	25V
C726	UU137220	C.EL	22uF	16V
C727	UU147100	C.EL	10uF	25V
C728	US135100	C.CE.CHP	0.1uF	16V
C729	UU137220	C.EL	22uF	16V
C730	US062470	C.CE.M.CHP	470pF	50V
C731	US063470	C.CE.CHP	4700pF	50V
C732	US135100	C.CE.CHP	0.1uF	16V
C733	UU128100	C.EL	100uF	10V
C735	US135100	C.CE.CHP	0.1uF	16V
C736	UU147100	C.EL	10uF	25V
C737	US135100	C.CE.CHP	0.1uF	16V
C738	UU147100	C.EL	10uF	25V
C739	US135100	C.CE.CHP	0.1uF	16V
C740	UU147100	C.EL	10uF	25V
C741	US135100	C.CE.CHP	0.1uF	16V
C742	UU147100	C.EL	10uF	25V
C743	US135100	C.CE.CHP	0.1uF	16V
C744	UU147100	C.EL	10uF	25V
C745	UU147100	C.EL	10uF	25V
C746	UU147100	C.EL	10uF	25V
C747	UU147100	C.EL	10uF	25V
C748	UU147100	C.EL	10uF	25V
C749	UU147100	C.EL	10uF	25V
C750	US063470	C.CE.CHP	4700pF	50V
D501	VT332900	DIODE	1SS355	
D502	VT332900	DIODE	1SS355	
D503	VT332900	DIODE	1SS355	
D504	VT332900	DIODE	1SS355	
D505	VT332900	DIODE	1SS355	
D506	VT332900	DIODE	1SS355(RLT)	
D507	VT332900	DIODE	1SS355(RLT)	
D508	VT332900	DIODE	1SS355(RLT)	
D509	VT332900	DIODE	1SS355	
D510	VT332900	DIODE	1SS355	

\* New Parts

Schm Ref.	PART NO.	Description		
D511	VT332900	DIODE	1SS355	
D512	VT332900	DIODE	1SS355	
D513	VT332900	DIODE	1SS355	
D514	VT332900	DIODE	1SS355	
D515	VT707700	C.TRIM	KV1851-TL(RLT)	
D516	VT332900	DIODE	1SS355	
D517	VT332900	DIODE	1SS355	
D518	VT332900	DIODE	1SS355	
D519	VT332900	DIODE	1SS355	
D520	VT332900	DIODE	1SS355	
D521	VT332900	DIODE	1SS355	
D522	VT332900	DIODE	1SS355	
D523	VT332900	DIODE	1SS355	
D524	VV220700	DIODE.SHOT	RB501V-40	
D525	VV220700	DIODE.SHOT	RB501V-40	
D526	VV220700	DIODE.SHOT	RB501V-40	
D527	VV220700	DIODE.SHOT	RB501V-40	
D528	VV220700	DIODE.SHOT	RB501V-40	
D529	VV220700	DIODE.SHOT	RB501V-40	
D530	VV220700	DIODE.SHOT	RB501V-40	
D531	VV220700	DIODE.SHOT	RB501V-40	
D532	VT332900	DIODE	1SS355	
D533	VT332900	DIODE	1SS355	
D534	VT332900	DIODE	1SS355	
D535	VT332900	DIODE	1SS355	
D536	VT332900	DIODE	1SS355	
D537	VT332900	DIODE	1SS355	
D538	VT332900	DIODE	1SS355	
IC501	XY580A00	IC	YSS928	
IC502	XV077A00	IC	MSM514260C-60JS	
IC503	XT958A00	IC	PM4007A(RLT)	
IC504	XW433A00	IC	CY62256LL(RLT)	
IC505	XZ003A00	IC	PQ025EZ5MZP 2.5V	
IC506	XU965A00	IC	uPC29M33T-E1 3.3V	
IC507	XD655A00	IC	TC74HC00AF NAND	
IC508	XV495A00	IC	TC74VHCT08AF AND	
IC509	XR038A00	IC	NJM2904M OP AMP	
IC510	XD660A00	IC	TC74HCU04AF-TP1	
IC511	XD660A00	IC	TC74HCU04AF-TP1	
IC512	XF291A00	IC	uPC4570G2(RLT)	
IC513	XD655A00	IC	TC74HC00AF NAND	
IC514	XZ002A00	IC	AK4527VQ	
IC515	XF291A00	IC	uPC4570G2	
IC516	XF291A00	IC	uPC4570G2	
IC517	XF291A00	IC	uPC4570G2	
IC518	XF291A00	IC	uPC4570G2	
IC519	XF291A00	IC	uPC4570G2	
IC520	XV058A00	IC	DF1704E	
IC521	XV057A00	IC	PCM1704U	
IC522	XV057A00	IC	PCM1704U	
IC523	XV058A00	IC	DF1704E	
IC524	XV057A00	IC	PCM1704U	
IC525	XF291A00	IC	uPC4570G2	

\* New Parts

## P.C.B. DSP &amp; F AMP

Schm Ref.	PART NO.	Description	
IC526	XF291A00	IC	uPC4570G2
IC527	XF291A00	IC	uPC4570G2
L501	V2726500	COIL	68uH
L502	V2726500	COIL	68uH
L503	V2726500	COIL	68uH
L504	V2726500	COIL	68uH
L505	V2726500	COIL	68uH
L506	VT623200	FLTR.LC	SBP-4930(RLT)
L507	V2726500	COIL	68uH(RLT)
PJ501	V5715300	JACK.PIN	2P(UCAG)
* PJ501	V6290500	JACK.PIN	3P(RTL)
Q501	iA103700	TR.CHP	2SA1037 Q,R,S(RLT)
Q502	VV556400	TR	2SC2412K Q,R,S(RLT)
Q503	VV556400	TR	2SC2412K Q,R,S(RLT)
Q504	VV556400	TR	2SC2412K Q,R,S(RLT)
Q505	iA103700	TR.CHP	2SA1037 Q,R,S(RLT)
Q506	VV556400	TR	2SC2412K Q,R,S(RLT)
Q507	VV556400	TR	2SC2412K Q,R,S(RLT)
Q508	iA103700	TR.CHP	2SA1037 Q,R,S(RLT)
Q509	VV655300	TR.DGT	DTA144EKA
Q510	VV655300	TR.DGT	DTA144EKA
Q511	VV655300	TR.DGT	DTA144EKA
Q512	VV655300	TR.DGT	DTA144EKA
Q513	VV655300	TR.DGT	DTA144EKA
Q514	VV655300	TR.DGT	DTA144EKA
Q515	VV655300	TR.DGT	DTA144EKA
Q516	VV655300	TR.DGT	DTA144EKA
Q517	VV655300	TR.DGT	DTA144EKA
Q518	VV655300	TR.DGT	DTA144EKA
Q519	VD303700	TR	2SC3326 A,B
Q520	VD303700	TR	2SC3326 A,B
Q521	VD303700	TR	2SC3326 A,B
Q522	VD303700	TR	2SC3326 A,B
Q523	VD303700	TR	2SC3326 A,B
Q524	VD303700	TR	2SC3326 A,B
Q525	VD303700	TR	2SC3326 A,B
Q526	VD303700	TR	2SC3326 A,B
Q527	VD303700	TR	2SC3326 A,B
R594	HV453100	R.CAR.FP	1 1/4W(RLT)
R595	HV453100	R.CAR.FP	1 1/4W(RLT)
R596	HV454100	R.CAR.FP	10 1/4W
R599	HV453100	R.CAR.FP	1 1/4W
R600	HV453100	R.CAR.FP	1 1/4W
R601	HV454220	R.CAR.FP	22 1/4W
R602	HV453220	R.CAR.FP	2.2 1/4W
R604	HV454220	R.CAR.FP	22 1/4W
R605	HV453220	R.CAR.FP	2.2 1/4W
R606	HV454100	R.CAR.FP	10 1/4W
R608	HV454220	R.CAR.FP	22 1/4W
R609	VU224000	R.MTL.FLM	0.22 1W J
R610	HV453220	R.CAR.FP	2.2 1/4W
R611	HV453220	R.CAR.FP	2.2 1/4W
R612	HV453220	R.CAR.FP	2.2 1/4W

\* New Parts

Schm Ref.	PART NO.	Description	
XL501	V3625700	RSNR.CRYS	24.576MHz
XL502	VT928600	RSNR.CRYS	18.432MHz(RLT)
* * * * *	V6602000	P.C.B.	F AMP(UC)
* * * * *	V6602100	P.C.B.	F AMP(RT)
* * * * *	V6602200	P.C.B.	F AMP(A)
* * * * *	V6602300	P.C.B.	F AMP(G)
* * * * *	V6602400	P.C.B.	F AMP(L)
CB311	VG879900	CN.BS.PIN	2P(RTA)
CB313	VP206500	HOLDER.FUS	EYF-52BCT(AGL)
CB313	VS996100	HOLDER.FUS	EYF64BC(UCRT)
CB314	VS996100	HOLDER.FUS	EYF64BC(UCRT)
CB315	VP206500	HOLDER.FUS	EYF-52BCT(ALG)
CB316	LA002410	TERM.WRAP	2P
CB317	VP206500	HOLDER.FUS	EYF-52BCT(RTGL)
CB318	VP206500	HOLDER.FUS	EYF-52BCT(RTGL)
CB319	LA002410	TERM.WRAP	2P(RT)
CB351	VD004500	CN.BS.PIN	2P
CB352	VL845000	CN.BS.PIN	6P
CB353	VP206500	HOLDER.FUS	EYF-52BCT
CB354	VP206500	HOLDER.FUS	EYF-52BCT
CB355	VP206500	HOLDER.FUS	EYF-52BCT
CB356	VP206500	HOLDER.FUS	EYF-52BCT
CB357	VD004500	CN.BS.PIN	2P
CB358	LA002320	TERM.WRAP	3P
CB359	LA002320	TERM.WRAP	3P
CB360	LA002000	TERM.WRAP	2P
CB361	VD005000	CN.BS.PIN	7P
CB362	VD004700	CN.BS.PIN	4P
CB363	VD005000	CN.BS.PIN	7P
CB901	V5906800	CN	JET 15P TE
CB902	VM929900	CN.BS.PIN	15P
C311	UU147100	C.EL	10uF 25V(UCAGL)
C311	UU148100	C.EL	100uF 25V(RT)
C312	UU147100	C.EL	10uF 25V(RT)
C313	UU167100	C.EL	10uF 50V(RT)
C314	UU197470	C.EL	47uF 100V(RT)
C315	Vi716700	C.MYLAR	0.01uF 50V(UCAGL)
C316	Vi716700	C.MYLAR	0.01uF 50V(RT)
C317	Vi716700	C.MYLAR	0.01uF 50V(RT)
* * * * *	C318	V6185300	C.CE.SAFETY 0.01uF 275V
C351	UU167100	C.EL	10uF 50V
C352	UU167100	C.EL	10uF 50V
* C353	UU157330	C.EL	33uF 35V
* C354	UU157330	C.EL	33uF 35V
C355	UU167100	C.EL	10uF 50V
C356	UU167100	C.EL	10uF 50V
C357	VF467000	C.CE.TUBLR	1000pF 50V
C358	UU137220	C.EL	22uF 16V
C359	VF466800	C.CE.TUBLR	100pF 50V
C360	VS696700	C.CE	33pF 500V

\* New Parts

P.C.B. F AMP

Schm Ref.	PART NO.	Description		
C361	UP652100	C. POL	100pF	100V
C362	UU148100	C. EL	100uF	25V
C363	UU137470	C. EL	47uF	16V
C364	UU137220	C. EL	22uF	16V
C365	VF466800	C. CE . TUBLR	100pF	50V
C366	VS696700	C. CE	33pF	500V
C367	UP652100	C. POL	100pF	100V
C368	UU148100	C. EL	100uF	25V
C369	UU137470	C. EL	47uF	16V
C370	VR325000	C. MYLAR	100pF	100V
C371	UA654100	C. MYLAR	0.01uF	50V
C372	UU138100	C. EL	100uF	16V
C373	VR325000	C. MYLAR	100pF	100V
C374	VR325000	C. MYLAR	100pF	100V
C375	UA654100	C. MYLAR	0.01uF	50V
C376	UU138100	C. EL	100uF	16V
C377	VR325000	C. MYLAR	100pF	100V
C378	UA654470	C. MYLAR	0.047uF	50V
C379	UA654470	C. MYLAR	0.047uF	50V
C380	UU159100	C. EL	1000uF	35V
C381	UU168100	C. EL	100uF	50V
C382	UU167100	C. EL	10uF	50V
C383	UU147100	C. EL	10uF	25V
C384	VL232400	C. EL	3300uF	35V
C385	VL232400	C. EL	3300uF	35V
C386	UU139680	C. EL	6800uF	16V
C387	UU13A100	C. EL	10000uF	16V
C388	UU13A100	C. EL	10000uF	16V
C389	UU139680	C. EL	6800uF	16V
C390	UU147100	C. EL	10uF	25V
C391	UU147100	C. EL	10uF	25V
△ C392	VR168300	C. MYLAR .ML	ECQ-V1H104JL3	
△ C393	VR168300	C. MYLAR .ML	ECQ-V1H104JL3	
C394	VH053100	C. CE . TUBLR	0.1uF	50V
C395	VR168300	C. MYLAR .ML	ECQ-V1H104JL3	
C396	VR168300	C. MYLAR .ML	ECQ-V1H104JL3	
C397	UU147100	C. EL	10uF	25V
C398	UU137470	C. EL	47uF	16V
C399	UU137470	C. EL	47uF	16V
C400	UU166100	C. EL	1uF	50V
C401	UU166100	C. EL	1uF	50V
C402	UU137470	C. EL	47uF	16V
C403	UU139100	C. EL	1000uF	16V
C404	UU139100	C. EL	1000uF	16V
C901	UU137470	C. EL	47uF	16V
C902	UU137470	C. EL	47uF	16V
C903	VF466800	C. CE . TUBLR	100pF	50V
C904	VF466800	C. CE . TUBLR	100pF	50V
C905	VF467300	C. CE . TUBLR	0.01uF	16V
C906	VF466800	C. CE . TUBLR	100pF	50V
C907	VF467000	C. CE . TUBLR	1000pF	50V
C908	VF466800	C. CE . TUBLR	100pF	50V
C911	VG278600	C. CE . TUBLR	330pF	50V(G)

Schm Ref.	PART NO.	Description		
C912	VG278600	C. CE . TUBLR	330pF	50V(G)
C913	VG278800	C. CE . TUBLR	560pF	50V(G)
C914	UU137470	C. EL	47uF	16V(G)
C915	UU137470	C. EL	47uF	16V(G)
C916	VA761100	C. CE	27pF	50V(G)
C917	VA761100	C. CE	27pF	50V(G)
C918	VJ599000	C. CE . TUBLR	0.047uF	16V(G)
C919	UU137470	C. EL	47uF	16V(G)
D311	iF004600	DIODE	1SS133	
D312	iF004600	DIODE	1SS133(RT)	
D313	VU264100	DIODE	1SR139-400(RT)	
△ D314	VR253700	DIODE .BRG	S1NB20	1.0A 200V
D315	VG439900	DIODE .ZENR	MTZJ11B	11V(RT)
D351	VG442800	DIODE .ZENR	MTZJ27A	27V
D352	VG442400	DIODE .ZENR	MTZJ24A	24V
D353	iF004600	DIODE	1SS133	
D354	iF004600	DIODE	1SS133	
D355	iF004600	DIODE	1SS133	
D356	iF004600	DIODE	1SS133	
D357	VG442600	DIODE .ZENR	MTZJ24C	24V
D358	VG440800	DIODE .ZENR	MTZJ15B	15V(RT)
D359	iF004600	DIODE	1SS133	
△ D360	VN011300	DIODE .BRG	D3SBA20	4A 200V
△ D361	VN011300	DIODE .BRG	D3SBA20	4A 200V
D901	VG437700	DIODE .ZENR	MTZJ5.6B	5.6V
△ F311	KB000780	FUSE	T5.0A	250V(AGL)
△ F311	KB001390	FUSE	10A	250V(UCRT)
△ F312	KB000780	FUSE	T5.0A	250V(RT)
△ F312	VT942900	FUSE	TH2.5A	250V(GL)
△ F351	KB003240	FUSE	T5.0A	250V(RTAGL)
△ F351	KB003640	FUSE	T6.0A	125V(UC)
△ F352	KB003240	FUSE	T5.0A	250V(RTAGL)
△ F352	KB003640	FUSE	T6.0A	125V(UC)
G351	VR463400	TERM .GND	D3.5	TP00385
IC351	iG092000	IC	M5220L	
△ IC352	XJ607A00	IC	NJM7805FA	5V
△ IC353	XE436A00	IC	NJM79M05FA	
△ IC354	XJ607A00	IC	NJM7805FA	5V
△ IC355	XJ608A00	IC	NJM7812FA	
△ IC356	XD343A00	IC	NJM79M12FA	
* IC901	XY534A00	IC	LC72722(G)	
L351	GD900470	COIL	1.5uH	
L352	GD900470	COIL	1.5uH	
L901	Vi546100	COIL	220uH(G)	
PN302	V3750100	PIN	L=50	
Q311	VD488500	TR .DGT	DTC143XS	
△ Q312	VR510800	TR	2SD2396 J,K(RT)	
△ Q313	VR510800	TR	2SD2396 J,K(RT)	
Q314	iE102620	FET	2SK246 Y(RT)	
Q315	iC174020	TR	2SC1740S R,S	
△ Q351	VP872700	TR	2SC4488 S,T	
△ Q352	VP872600	TR	2SA1708 S,T	
△ Q353	VP872700	TR	2SC4488 S,T	

\* New Parts

\* New Parts

## P.C.B. F AMP &amp; MAIN

Schm Ref.	PART NO.	Description
△	Q354	VK174800 TR 2SC4512 O,P,Y
△	Q355	VP872600 TR 2SA1708 S,T
	Q356	iC224030 TR 2SC2240 GR,BL
△	Q357	VK174800 TR 2SC4512 O,P,Y
△	Q358	VP872700 TR 2SC4488 S,T
△	Q359	VK174800 TR 2SC4512 O,P,Y
△	Q360	VP872600 TR 2SA1708 S,T
	Q361	iC224030 TR 2SC2240 GR,BL
△	Q362	VK174800 TR 2SC4512 O,P,Y
	Q363	iC224030 TR 2SC2240 GR,BL
	Q364	iC224030 TR 2SC2240 GR,BL
△ *	Q365	V6678600 TR 2SB1375
	Q366	iC1815C0 TR 2SC1815 Y
	Q901	iC1815C0 TR 2SC1815 Y
	Q902	iC174020 TR 2SC1740S R,S(G)
	R351	HV453470 R. CAR. FP 4.7 1/4W
	R354	HV453470 R. CAR. FP 4.7 1/4W
	R361	HV455220 R. CAR. FP 220 1/4W
	R367	HV455220 R. CAR. FP 220 1/4W
△	R369	HV455330 R. CAR. FP 330 1/4W
△	R370	VE869300 R. MTL. OXD 0.1 2W
△	R371	HV456150 R. CAR. FP 1.5K 1/4W
△	R374	HV456220 R. CAR. FP 2.2K 1/4W
△	R375	HV455100 R. CAR. FP 100 1/4W
△	R376	HV455100 R. CAR. FP 100 1/4W
△	R378	HV456150 R. CAR. FP 1.5K 1/4W
△	R379	HV455330 R. CAR. FP 330 1/4W
△	R380	VE869300 R. MTL. OXD 0.1 2W
△	R382	HV456220 R. CAR. FP 2.2K 1/4W
△	R384	HV455100 R. CAR. FP 100 1/4W
△	R385	HV455100 R. CAR. FP 100 1/4W
	R389	HV454100 R. CAR. FP 10 1/4W
	R390	HV453470 R. CAR. FP 4.7 1/4W
	R391	HV453470 R. CAR. FP 4.7 1/4W
	R393	HV454100 R. CAR. FP 10 1/4W
△	R394	HV453470 R. CAR. FP 4.7 1/4W
	R395	HV456330 R. CAR. FP 3.3K 1/4W
	R396	HV456470 R. CAR. FP 4.7K 1/4W
	R400	HL314100 R. MTL. OXD 10 1W
△	R402	HL324100 R. MTL. OXD 10 2W
△	R403	HL324100 R. MTL. OXD 10 2W
△	R404	VP939900 R. MTL. OXD 15 1W
△	R405	VP939900 R. MTL. OXD 15 1W
△	R411	HL324100 R. MTL. OXD 10 2W
△	R412	VP939500 R. MTL. FLM 1 1W
△	R413	VP939900 R. MTL. OXD 15 1W
△	R414	VP939500 R. MTL. FLM 1 1W
△ *	RY311	V6434900 RELAY DC DLS12D1-0
	ST311	BB071360 SCR. TERM 8.3x13
	ST901	BB071360 SCR. TERM 8.3x13
	SW901	VF541200 SW. SLIDE SSSF11(RT)
△ *	T311	XZ228A00 TRANS. PWR (UC)
△ *	T311	XZ229A00 TRANS. PWR (RT)

\* New Parts

Schm Ref.	PART NO.	Description
△ *	T311	XZ230A00 TRANS. PWR (A)
△ *	T311	XZ231A00 TRANS. PWR (GL)
△ *	TE311	V5867900 AC OUTLET 3P(RT)
△	TE311	VT915000 OUTLET.AC 2P(A)
△	TE311	VV118800 OUTLET.AC 3P(UC)
△	TE311	VV119000 OUTLET.AC 3P(GL)
△ *	TE312	V6561200 AC INLET 2P M1908-G(UCGL)
	TH351	VM842300 POSISTOR PTH9M04 BF/80° C
*	XL901	V2731100 RSNR. CRYST 4.332M HC-49/U(G)
*	V6604000	P. C. B. MAIN(UC)
*	V6604100	P. C. B. MAIN(RT)
*	V6604200	P. C. B. MAIN(A)
*	V6604300	P. C. B. MAIN(G)
*	V6604400	P. C. B. MAIN(L)
	CB1	VM973500 CN. BS. PIN 17P
	CB3	LA002000 TERM. WRAP 2P
	CB4	LB919040 CN. BS. PIN 4P
	CB5	LA002320 TERM. WRAP 3P
	CB6	LB919040 CN. BS. PIN 4P
	C1	UU118100 C. EL 100uF 6.3V
	C2	UU167100 C. EL 10uF 50V
	C3	VH053100 C. CE. TUBLR 0.1uF 50V
	C4	UU167100 C. EL 10uF 50V
	C5	UU197100 C. EL 10uF 100V
	C6	UU197100 C. EL 10uF 100V
	C7	UU197470 C. EL 47uF 100V
	C9	VF467300 C. CE. TUBLR 0.01uF 16V(RTALG)
	C11	UP652100 C. POL 100pF 100V
	C12	UP652100 C. POL 100pF 100V
	C13	UA654100 C. MYLAR 0.01uF 50V
	C14	UU197100 C. EL 10uF 100V
	C15	UP652100 C. POL 100pF 100V
	C16	UU197100 C. EL 10uF 100V
	C17	UP652100 C. POL 100pF 100V
	C18	VK533900 C. PP 100pF 200V
	C19	UP653120 C. POL 1200pF 100V
	C20	UU197470 C. EL 47uF 100V
	C21	UA653330 C. MYLAR 3300pF 50V
	C22	UA654100 C. MYLAR 0.01uF 50V
	C23	UP652100 C. POL 100pF 100V
	C24	VM645500 C. PP 15uF 200V
	C25	UU147100 C. EL 10uF 25V
	C26	UU138100 C. EL 100uF 16V
	C27	UU166470 C. EL 4.7uF 50V
	C28	UU165100 C. EL 0.1uF 50V
	C29	UP652100 C. POL 100pF 100V
*	C30	UU157330 C. EL 33uF 35V
	C31	UU167100 C. EL 10uF 50V
	C32	VK533900 C. PP 100pF 200V
	C33	UU148100 C. EL 100uF 25V

\* New Parts

P.C.B. MAIN

Schm Ref.	PART NO.	Description		
C34	VK533900	C. PP	100pF	200V
C35	UP653120	C. POL	1200pF	100V
C36	UU197470	C. EL	47uF	100V
C37	UA653330	C. MYLAR	3300pF	50V
C38	UA654100	C. MYLAR	0.01uF	50V
C39	UP652100	C. POL	100pF	100V
C40	VM645500	C. PP	15uF	200V
C41	UU147100	C. EL	10uF	25V
C42	UU138100	C. EL	100uF	16V
C43	UU166470	C. EL	4.7uF	50V
C44	UU165100	C. EL	0.1uF	50V
C45	UP652100	C. POL	100pF	100V
* C46	UU157330	C. EL	33uF	35V
C47	UU167100	C. EL	10uF	50V
C48	VK533900	C. PP	100pF	200V
C49	UU148100	C. EL	100uF	25V
C50	UU197470	C. EL	47uF	100V
C51	UP653120	C. POL	1200pF	100V
C52	UA653330	C. MYLAR	3300pF	50V
C53	UP652100	C. POL	100pF	100V
C54	VR516400	C. CE	15pF	500V
C55	UU147100	C. EL	10uF	25V
C56	UU138100	C. EL	100uF	16V
C57	UU165100	C. EL	0.1uF	50V
C58	UP652100	C. POL	100pF	100V
* C59	UU157330	C. EL	33uF	35V
C60	UU167100	C. EL	10uF	50V
C61	VK533900	C. PP	100pF	200V
C62	UU148100	C. EL	100uF	25V
C63	UU197470	C. EL	47uF	100V
C64	UP653120	C. POL	1200pF	100V
C65	UA653330	C. MYLAR	3300pF	50V
C66	UP652100	C. POL	100pF	100V
C67	VR516400	C. CE	15pF	500V
C68	UU147100	C. EL	10uF	25V
C69	UU138100	C. EL	100uF	16V
C70	UU165100	C. EL	0.1uF	50V
C71	UP652100	C. POL	100pF	100V
* C72	UU157330	C. EL	33uF	35V
C73	UU167100	C. EL	10uF	50V
C74	VK533900	C. PP	100pF	200V
C75	UU148100	C. EL	100uF	25V
C76	VK533900	C. PP	100pF	200V
C77	UP653120	C. POL	1200pF	100V
C78	UU197470	C. EL	47uF	100V
C79	UA653330	C. MYLAR	3300pF	50V
C80	UP652100	C. POL	100pF	100V
C81	VR516400	C. CE	15pF	500V
C82	UA654100	C. MYLAR	0.01uF	50V
C83	UU147100	C. EL	10uF	25V
C84	UU166470	C. EL	4.7uF	50V
C85	UU138100	C. EL	100uF	16V
C86	UU165100	C. EL	0.1uF	50V

\* New Parts

Schm Ref.	PART NO.	Description		
C87	UP652100	C. POL	100pF	100V
* C88	UU157330	C. EL	33uF	35V
C89	UU167100	C. EL	10uF	50V
C90	VK533900	C. PP	100pF	200V
C91	UU148100	C. EL	100uF	25V
C92	VK533900	C. PP	100pF	200V
C93	UP653120	C. POL	1200pF	100V
C94	UU197470	C. EL	47uF	100V
C95	UA653330	C. MYLAR	3300pF	50V
C96	UA654100	C. MYLAR	0.01uF	50V
C97	UP652100	C. POL	100pF	100V
C98	VR516400	C. CE	15pF	500V
C99	UU147100	C. EL	10uF	25V
C100	UU138100	C. EL	100uF	16V
C101	UU166470	C. EL	4.7uF	50V
C102	UU165100	C. EL	0.1uF	50V
C103	UP652100	C. POL	100pF	100V
* C104	UU157330	C. EL	33uF	35V
C105	UU167100	C. EL	10uF	50V
C106	VK533900	C. PP	100pF	200V
C107	UU148100	C. EL	100uF	25V
C108	UU166330	C. EL	3.3uF	50V
C109	VR169000	C. MYLAR . ML	ECQ-V1H334JL3	
* C110	UU138330	C. EL	330uF	16V
C111	UA654470	C. MYLAR	0.047uF	50V
C112	VR169000	C. MYLAR . ML	ECQ-V1H334JL3	
* C113	UU138330	C. EL	330uF	16V
C114	UA654470	C. MYLAR	0.047uF	50V
C115	VK533900	C. PP	100pF	200V
C116	UA654100	C. MYLAR	0.01uF	50V
C117	UU166470	C. EL	4.7uF	50V
* C118	UU138330	C. EL	330uF	16V
C119	UA654470	C. MYLAR	0.047uF	50V
C120	VK533900	C. PP	100pF	200V
C121	UA654100	C. MYLAR	0.01uF	50V
C122	UU166470	C. EL	4.7uF	50V
* C123	UU138330	C. EL	330uF	16V
C124	UA654470	C. MYLAR	0.047uF	50V
* C125	UU138330	C. EL	330uF	16V
C126	UA654470	C. MYLAR	0.047uF	50V
* C127	UU138330	C. EL	330uF	16V
C128	UA654470	C. MYLAR	0.047uF	50V
C129	UU197100	C. EL	10uF	100V
C130	UU197100	C. EL	10uF	100V
C131	UU197100	C. EL	10uF	100V
C132	UU197100	C. EL	10uF	100V
C133	UU197100	C. EL	10uF	100V
C134	UU197100	C. EL	10uF	100V
C135	UU197100	C. EL	10uF	100V
C136	UU197100	C. EL	10uF	100V
C137	UU197100	C. EL	10uF	100V
C138	UU197100	C. EL	10uF	100V
C139	UU128100	C. EL	100uF	10V

\* New Parts



## P.C.B. MAIN

Schm Ref.	PART NO.	Description		
C140	UU197100	C.EL	10uF	100V
C141	UU197100	C.EL	10uF	100V
C142	Vi862100	C.POL.MTL	0.047uF	100V
* C143	V6512400	C.EL	22000uF	71V
C144	Vi862100	C.POL.MTL	0.047uF	100V
* C145	V6512400	C.EL	22000uF	71V
C146	Vi862200	C.POLY	0.1uF	100V
C147	UA654100	C.MYLAR	0.01uF	50V(RTALG)
C148	UA654100	C.MYLAR	0.01uF	50V(RTALG)
C149	UA654100	C.MYLAR	0.01uF	50V(RTALG)
C150	UA654100	C.MYLAR	0.01uF	50V(RTALG)
C151	UA654100	C.MYLAR	0.01uF	50V(RTALG)
C152	UA654100	C.MYLAR	0.01uF	50V(RTALG)
C153	UA654100	C.MYLAR	0.01uF	50V(RTALG)
C154	UA654100	C.MYLAR	0.01uF	50V(RTALG)
C155	UA654100	C.MYLAR	0.01uF	50V(RTALG)
C156	UA654100	C.MYLAR	0.01uF	50V(RTALG)
C157	UA654100	C.MYLAR	0.01uF	50V(RTALG)
C158	UA654100	C.MYLAR	0.01uF	50V(RTALG)
C159	UA654100	C.MYLAR	0.01uF	50V(RTALG)
C160	UA654100	C.MYLAR	0.01uF	50V(RTALG)
C161	UA654100	C.MYLAR	0.01uF	50V(RTALG)
C162	UA654100	C.MYLAR	0.01uF	50V(RTALG)
C163	UA654100	C.MYLAR	0.01uF	50V(RTALG)
C164	UA654100	C.MYLAR	0.01uF	50V(RTALG)
C165	UA654100	C.MYLAR	0.01uF	50V(RTALG)
C166	UA654100	C.MYLAR	0.01uF	50V(RTALG)
C167	UU128100	C.EL	100uF	10V
C168	UU128100	C.EL	100uF	10V
D1	iF004600	DIODE	1SS133	
D2	iF004600	DIODE	1SS133	
D3	iF004600	DIODE	1SS133	
D4	VG443500	DIODE.ZENR	MTZJ30D	30V
D5	iF004600	DIODE	1SS133	
* D6	VG441700	DIODE.ZENR	MTZ J 20.0B(UC)	
D6	VG442100	DIODE.ZENR	MTZJ22B(RTAGL)	
* D7	VG441700	DIODE.ZENR	MTZ J 20.0B(UC)	
D7	VG442100	DIODE.ZENR	MTZJ22B(RTAGL)	
D8	iF004600	DIODE	1SS133	
D9	iF004600	DIODE	1SS133	
D10	VG440100	DIODE.ZENR	MTZJ12A	12V
△ D11	VC398400	DIODE	MA185	
D12	iF004600	DIODE	1SS133	
△ D13	VG440100	DIODE.ZENR	MTZJ12A	12V
△ D14	VC398400	DIODE	MA185	
D15	iF004600	DIODE	1SS133	
△ D16	VG440100	DIODE.ZENR	MTZJ12A	12V
△ D17	VC398400	DIODE	MA185	
D18	iF004600	DIODE	1SS133	
D19	VG440100	DIODE.ZENR	MTZJ12A	12V
△ D20	VC398400	DIODE	MA185	
△ D21	VC398400	DIODE	MA185	
D22	iF004600	DIODE	1SS133	

\* New Parts

Schm Ref.	PART NO.	Description		
△ D23	VC398400	DIODE	MA185	
D24	VG440100	DIODE.ZENR	MTZJ12A	12V
△ D25	VC398400	DIODE	MA185	
D26	iF004600	DIODE	1SS133	
△ D27	VC398400	DIODE	MA185	
D28	VG440100	DIODE.ZENR	MTZJ12A	12V
△ D29	VC398400	DIODE	MA185	
△ D30	VU264100	DIODE	1SR139-400	
△ D31	VC398400	DIODE	MA185	
△ D32	VC398400	DIODE	MA185	
△ D33	VU264100	DIODE	1SR139-400	
△ D34	VC398400	DIODE	MA185	
△ D35	VC398400	DIODE	MA185	
△ D36	VU264100	DIODE	1SR139-400	
△ D37	VC398400	DIODE	MA185	
△ D38	VC398400	DIODE	MA185	
△ D39	VU264100	DIODE	1SR139-400	
△ D40	VC398400	DIODE	MA185	
△ D41	VC398400	DIODE	MA185	
△ D42	VU264100	DIODE	1SR139-400	
△ D43	VC398400	DIODE	MA185	
△ D44	VC398400	DIODE	MA185	
△ D45	VU264100	DIODE	1SR139-400	
△ D46	VC398400	DIODE	MA185	
△ D47	VC398400	DIODE	MA185	
D48	VC398400	DIODE	MA185	
D49	VC398400	DIODE	MA185	
D51	iF004600	DIODE	1SS133	
D52	iF004600	DIODE	1SS133	
△ D53	VZ755200	DIODE.BRG	D15XB20	15A 200V
D54	iF004600	DIODE	1SS133	
D55	iF004600	DIODE	1SS133	
D56	VG437200	DIODE.ZENR	MTZJ4.7C	4.7V
D57	VG437200	DIODE.ZENR	MTZJ4.7C	4.7V
△ D58	VC398400	DIODE	MA185	
△ D59	VC398400	DIODE	MA185	
△ D60	VC398400	DIODE	MA185	
D61	iF004600	DIODE	1SS133	
D62	iF004600	DIODE	1SS133	
D63	iF004600	DIODE	1SS133	
D64	iF004600	DIODE	1SS133	
D65	iF004600	DIODE	1SS133	
D66	iF004600	DIODE	1SS133	
G1	VR463400	TERM.GND	D3.5	TP00385
G2	VR463400	TERM.GND	D3.5	TP00385
HS1	VY843300	HEAT.SINK		
L1	VC664100	COIL	0.95uH	
L2	VC664100	COIL	0.95uH	
L3	GD900470	COIL	1.5uH	
L4	GD900470	COIL	1.5uH	
L5	GD900470	COIL	1.5uH	
L6	GD900470	COIL	1.5uH	
PN1	V3750100	PIN	L=50	

\* New Parts

P.C.B. MAIN

Schm Ref.	PART NO.	Description
Q1	iC174020	TR 2SC1740S R, S
Q2	VK165500	TR .DGT DTC123JS TP
* Q3	V6678600	TR 2SB1375
Q4	VT254500	TR .DGT DTC143ZS
Q5	VT254500	TR .DGT DTC143ZS
△ Q6	VR510800	TR 2SD2396 J, K
Q7	VP883100	TR 2SC1890A D, E
Q8	VP883000	TR 2SA893A D, E
△ Q9	VS883300	TR 2SB1565 E, F
△ Q10	iA101521	TR 2SA1015 Y
△ Q11	iA101521	TR 2SA1015 Y
△ Q12	VE198700	TR 2SA1145 O, Y
△ Q13	iC224030	TR 2SC2240 GR, BL
△ Q14	iC224030	TR 2SC2240 GR, BL
△ Q15	iC224030	TR 2SC2240 GR, BL
△ Q16	iC224030	TR 2SC2240 GR, BL
△ Q17	iA101521	TR 2SA1015 Y
△ Q18	iA101521	TR 2SA1015 Y
△ Q19	VE198700	TR 2SA1145 O, Y
△ Q20	iC224030	TR 2SC2240 GR, BL
△ Q21	iC224030	TR 2SC2240 GR, BL
△ Q22	iC224030	TR 2SC2240 GR, BL
△ Q23	iC224030	TR 2SC2240 GR, BL
△ Q24	iA101521	TR 2SA1015 Y
△ Q25	iA101521	TR 2SA1015 Y
△ Q26	VE198700	TR 2SA1145 O, Y
△ Q27	iC224030	TR 2SC2240 GR, BL
△ Q28	iC224030	TR 2SC2240 GR, BL
△ Q29	iC224030	TR 2SC2240 GR, BL
△ Q30	iC224030	TR 2SC2240 GR, BL
△ Q31	iA101521	TR 2SA1015 Y
△ Q32	iA101521	TR 2SA1015 Y
△ Q33	VE198700	TR 2SA1145 O, Y
△ Q34	iC224030	TR 2SC2240 GR, BL
△ Q35	iC224030	TR 2SC2240 GR, BL
△ Q36	iC224030	TR 2SC2240 GR, BL
△ Q37	iC224030	TR 2SC2240 GR, BL
△ Q38	iA101521	TR 2SA1015 Y
△ Q39	iA101521	TR 2SA1015 Y
△ Q40	VE198700	TR 2SA1145 O, Y
△ Q41	iC224030	TR 2SC2240 GR, BL
△ Q42	iC224030	TR 2SC2240 GR, BL
△ Q43	iC224030	TR 2SC2240 GR, BL
△ Q44	iC224030	TR 2SC2240 GR, BL
△ Q45	iA101521	TR 2SA1015 Y
△ Q46	iA101521	TR 2SA1015 Y
△ Q47	VE198700	TR 2SA1145 O, Y
△ Q48	iC224030	TR 2SC2240 GR, BL
△ Q49	iC224030	TR 2SC2240 GR, BL
△ Q50	iC224030	TR 2SC2240 GR, BL
△ Q51	iC224030	TR 2SC2240 GR, BL
△ Q52	VE198800	TR 2SC2705 O, Y
△ Q53A	iX632610	TR 2SA1837 O, Y

Schm Ref.	PART NO.	Description
△ Q53C	iX632620	TR 2SC4793 O, Y
△ # Q54	VY705000	TR 2SC5200 R, O
△ Q55	iC224030	TR 2SC2240 GR, BL
△ Q57	VE198700	TR 2SA1145 O, Y
△ # Q58	VY705000	TR 2SC5200 R, O
△ Q59	VE198800	TR 2SC2705 O, Y
△ Q60A	iX632610	TR 2SA1837 O, Y
△ Q60C	iX632620	TR 2SC4793 O, Y
△ # Q61	VY705000	TR 2SC5200 R, O
△ Q62	iC224030	TR 2SC2240 GR, BL
△ Q64	VE198700	TR 2SA1145 O, Y
△ # Q65	VY705000	TR 2SC5200 R, O
△ Q66	VE198800	TR 2SC2705 O, Y
△ Q67A	iX632610	TR 2SA1837 O, Y
△ Q67C	iX632620	TR 2SC4793 O, Y
△ # Q68	V6063900	TR 2SC5358 O, R
△ Q69	iC224030	TR 2SC2240 GR, BL
△ Q71	VE198700	TR 2SA1145 O, Y
△ # Q72	V6063900	TR 2SC5358 O, R
△ Q73	VE198800	TR 2SC2705 O, Y
△ Q74A	iX632610	TR 2SA1837 O, Y
△ Q74C	iX632620	TR 2SC4793 O, Y
△ # Q75	V6063900	TR 2SC5358 O, R
△ Q76	iC224030	TR 2SC2240 GR, BL
△ Q78	VE198700	TR 2SA1145 O, Y
△ # Q79	V6063900	TR 2SC5358 O, R
△ Q80	VE198800	TR 2SC2705 O, Y
△ Q81A	iX632610	TR 2SA1837 O, Y
△ Q81C	iX632620	TR 2SC4793 O, Y
△ # Q82	V6063900	TR 2SC5358 O, R
△ Q83	iC224030	TR 2SC2240 GR, BL
△ Q85	VE198700	TR 2SA1145 O, Y
△ # Q86	V6063900	TR 2SC5358 O, R
△ Q87	VE198800	TR 2SC2705 O, Y
△ Q88A	iX632610	TR 2SA1837 O, Y
△ Q88C	iX632620	TR 2SC4793 O, Y
△ # Q89	V6063900	TR 2SC5358 O, R
△ Q90	iC224030	TR 2SC2240 GR, BL
△ Q92	VE198700	TR 2SA1145 O, Y
△ # Q93	V6063900	TR 2SC5358 O, R
△ Q94	iA097000	TR 2SA970 GR, BL
△ R1	HL315150	R. MTL. OXD 150 1W
△ R4	HL315150	R. MTL. OXD 150 1W
△ R5	HV455220	R. CAR. FP 220 1/4W
△ R6	HV455220	R. CAR. FP 220 1/4W
△ R7	HV454100	R. CAR. FP 10 1/4W
△ R8	HV456330	R. CAR. FP 3.3K 1/4W
△ R9	HV455100	R. CAR. FP 100 1/4W
△ R10	HV455100	R. CAR. FP 100 1/4W
△ R13	HV455100	R. CAR. FP 100 1/4W
△ R14	HV455100	R. CAR. FP 100 1/4W
△ R15	HV456470	R. CAR. FP 4.7K 1/4W
△ R16	HV454100	R. CAR. FP 10 1/4W

\* New Parts

\* New Parts

90 Note) Those parts marked with "#" are not included in the P.C.B. ass'y.

## P.C.B. MAIN

Schm Ref.	PART NO.	Description		
△ R17	HL315100	R.MTL.OXD	100	1W
△ R32	HV454470	R.CAR.FP	47	1/4W
△ R33	HV455680	R.CAR.FP	680	1/4W
△ R34	HV455680	R.CAR.FP	680	1/4W
△ R35	HV455100	R.CAR.FP	100	1/4W
△ R37	HV455470	R.CAR.FP	470	1/4W
△ R42	HV455470	R.CAR.FP	470	1/4W
△ R45	HV456680	R.CAR.FP	6.8K	1/4W
△ R50	HV455120	R.CAR.FP	120	1/4W
△ R52	HV456680	R.CAR.FP	6.8K	1/4W
△ R53	HV454470	R.CAR.FP	47	1/4W
△ R54	HV455680	R.CAR.FP	680	1/4W
△ R55	HV455680	R.CAR.FP	680	1/4W
△ R56	HV455100	R.CAR.FP	100	1/4W
△ R58	HV455470	R.CAR.FP	470	1/4W
△ R63	HV455470	R.CAR.FP	470	1/4W
△ R66	HV456680	R.CAR.FP	6.8K	1/4W
△ R71	HV455120	R.CAR.FP	120	1/4W
△ R73	HV456680	R.CAR.FP	6.8K	1/4W
△ R74	HV454470	R.CAR.FP	47	1/4W
△ R75	HV455680	R.CAR.FP	680	1/4W
△ R76	HV455680	R.CAR.FP	680	1/4W
△ R77	HV455100	R.CAR.FP	100	1/4W
△ R79	HV455470	R.CAR.FP	470	1/4W
△ R84	HV455470	R.CAR.FP	470	1/4W
△ R87	HV456680	R.CAR.FP	6.8K	1/4W
△ R92	HV455120	R.CAR.FP	120	1/4W
△ R94	HV456680	R.CAR.FP	6.8K	1/4W
△ R95	HV455680	R.CAR.FP	680	1/4W
△ R96	HV455680	R.CAR.FP	680	1/4W
△ R97	HV455100	R.CAR.FP	100	1/4W
△ R99	HV455470	R.CAR.FP	470	1/4W
△ R104	HV455470	R.CAR.FP	470	1/4W
△ R107	HV456680	R.CAR.FP	6.8K	1/4W
△ R112	HV455120	R.CAR.FP	120	1/4W
△ R114	HV456680	R.CAR.FP	6.8K	1/4W
△ R116	HV455680	R.CAR.FP	680	1/4W
△ R117	HV455680	R.CAR.FP	680	1/4W
△ R118	HV455100	R.CAR.FP	100	1/4W
△ R120	HV455470	R.CAR.FP	470	1/4W
△ R125	HV455470	R.CAR.FP	470	1/4W
△ R128	HV456680	R.CAR.FP	6.8K	1/4W
△ R133	HV455120	R.CAR.FP	120	1/4W
△ R134	HV456680	R.CAR.FP	6.8K	1/4W
△ R137	HV455680	R.CAR.FP	680	1/4W
△ R138	HV455680	R.CAR.FP	680	1/4W
△ R139	HV455100	R.CAR.FP	100	1/4W
△ R141	HV455470	R.CAR.FP	470	1/4W
△ R146	HV455470	R.CAR.FP	470	1/4W
△ R150	HV456680	R.CAR.FP	6.8K	1/4W
△ R154	HV455120	R.CAR.FP	120	1/4W
△ R155	HV456680	R.CAR.FP	6.8K	1/4W
△ R159	HV453470	R.CAR.FP	4.7	1/4W

\* New Parts

Schm Ref.	PART NO.	Description		
△ R161	HV456120	R.CAR.FP	1.2K	1/4W
△ R162	HV455150	R.CAR.FP	150	1/4W
△ R164	HV455150	R.CAR.FP	150	1/4W
△ R165	VR412900	R.MTL.OXD	0.1	3W
△ R169	HV453470	R.CAR.FP	4.7	1/4W
△ R170	HV455470	R.CAR.FP	470	1/4W
△ R171	HV453470	R.CAR.FP	4.7	1/4W
△ R172	HV455100	R.CAR.FP	100	1/4W
△ R173	HV455560	R.CAR.FP	560	1/4W
△ R175	HV453470	R.CAR.FP	4.7	1/4W
△ R177	HV456120	R.CAR.FP	1.2K	1/4W
△ R178	HV455150	R.CAR.FP	150	1/4W
△ R180	HV455150	R.CAR.FP	150	1/4W
△ R181	VR412900	R.MTL.OXD	0.1	3W
△ R185	HV453470	R.CAR.FP	4.7	1/4W
△ R186	HV455470	R.CAR.FP	470	1/4W
△ R187	HV453470	R.CAR.FP	4.7	1/4W
△ R188	HV455100	R.CAR.FP	100	1/4W
△ R189	HV455560	R.CAR.FP	560	1/4W
△ R191	HV453470	R.CAR.FP	4.7	1/4W
△ R192	HV456120	R.CAR.FP	1.2K	1/4W
△ R193	HV455150	R.CAR.FP	150	1/4W
△ R194	HV455150	R.CAR.FP	150	1/4W
△ R195	VR412900	R.MTL.OXD	0.1	3W
△ R199	HV453470	R.CAR.FP	4.7	1/4W
△ R200	HV455470	R.CAR.FP	470	1/4W
△ R201	HV453470	R.CAR.FP	4.7	1/4W
△ R202	HV455100	R.CAR.FP	100	1/4W
△ R203	HV455560	R.CAR.FP	560	1/4W
△ R205	HV453470	R.CAR.FP	4.7	1/4W
△ R206	HV456120	R.CAR.FP	1.2K	1/4W
△ R207	HV455150	R.CAR.FP	150	1/4W
△ R208	HV455150	R.CAR.FP	150	1/4W
△ R209	VR412900	R.MTL.OXD	0.1	3W
△ R213	HV453470	R.CAR.FP	4.7	1/4W
△ R214	HV455470	R.CAR.FP	470	1/4W
△ R215	HV453470	R.CAR.FP	4.7	1/4W
△ R216	HV455100	R.CAR.FP	100	1/4W
△ R217	HV455560	R.CAR.FP	560	1/4W
△ R219	HV453470	R.CAR.FP	4.7	1/4W
△ R220	HV456120	R.CAR.FP	1.2K	1/4W
△ R221	HV455150	R.CAR.FP	150	1/4W
△ R222	HV455150	R.CAR.FP	150	1/4W
△ R223	VR412900	R.MTL.OXD	0.1	3W
△ R227	HV453470	R.CAR.FP	4.7	1/4W
△ R228	HV455470	R.CAR.FP	470	1/4W
△ R229	HV453470	R.CAR.FP	4.7	1/4W
△ R230	HV455100	R.CAR.FP	100	1/4W
△ R231	HV455560	R.CAR.FP	560	1/4W
△ R233	HV453470	R.CAR.FP	4.7	1/4W
△ R234	HV456120	R.CAR.FP	1.2K	1/4W
△ R235	HV455150	R.CAR.FP	150	1/4W
△ R236	HV455150	R.CAR.FP	150	1/4W

\* New Parts

**P.C.B. MAIN & FUNCTION**

Schm Ref.	PART NO.	Description		
△ R237	VR412900	R.MTL.OXD	0.1	3W
△ R241	HV453470	R.CAR.FP	4.7	1/4W
△ R242	HV455470	R.CAR.FP	470	1/4W
△ R243	HV453470	R.CAR.FP	4.7	1/4W
△ R244	HV455100	R.CAR.FP	100	1/4W
△ R245	HV455560	R.CAR.FP	560	1/4W
△ R250	HV454100	R.CAR.FP	10	1/4W
△ R251	HV453100	R.CAR.FP	1	1/4W
△ R253	HV454100	R.CAR.FP	10	1/4W
△ R254	HV453100	R.CAR.FP	1	1/4W
△ R255	HV454100	R.CAR.FP	10	1/4W
△ R257	HV453100	R.CAR.FP	1	1/4W
△ R258	HV454100	R.CAR.FP	10	1/4W
△ R261	HV453100	R.CAR.FP	1	1/4W
△ R262	HV454100	R.CAR.FP	10	1/4W
△ R265	HV453100	R.CAR.FP	1	1/4W
△ R267	HV454100	R.CAR.FP	10	1/4W
△ R269	HV453100	R.CAR.FP	1	1/4W
* RY1	V6322600	RELAY	DC DH24D2-0T(M)-SL	
* RY2	V6322600	RELAY	DC DH24D2-0T(M)-SL	
* RY3	V6322600	RELAY	DC DH24D2-0T(M)-SL	
* RY4	V6322600	RELAY	DC DH24D2-0T(M)-SL	
* RY5	V6322600	RELAY	DC DH24D2-0T(M)-SL	
SW1	VZ075500	SW.SLIDE	SL14-22AM5F	
* TE1	V5909700	TERM.SP	4P(GL)	
* TE1	V5909800	TERM.SP	4P(UCRTA)	
* TE2	V5909900	TERM.SP	8P(GL)	
* TE2	V5910000	TERM.SP	8P(UCRTA)	
* TE3	V5909900	TERM.SP	8P(GL)	
* TE3	V5910000	TERM.SP	8P(UCRTA)	
	VK697600	SCR.BND.HD	3x10 SP ZMC2-Y	
*	V6605000	P.C.B.	FUNCTION(UC)	
*	V6605100	P.C.B.	FUNCTION(RT)	
*	V6605200	P.C.B.	FUNCTION(AL)	
*	V6605300	P.C.B.	FUNCTION(G)	
CB501	VQ963200	CN.BS.PIN	11P	
CB502	VQ047900	CN	29P	
CB503	VQ963200	CN.BS.PIN	11P	
CB505	VM929900	CN.BS.PIN	15P	
CB507	VB858200	CN.BS.PIN	3P	
CB508	VQ047400	CN.BS.PIN	19P	
CB509	VQ044500	CN.BS.PIN	11P	
CB510	VM859600	CN.BS.PIN	15P	
CB511	VM973500	CN.BS.PIN	17P	
CB512	VB858400	CN.BS.PIN	5P	
CB513	VB858200	CN.BS.PIN	3P	
CB515	VQ047300	CN.BS.PIN	12P	
CB516	VF982200	CN.BS.PIN	14P	
CB517	VB858200	CN.BS.PIN	3P	
C501	VD930900	C.CE.SMI	0.1uF	25V

\* New Parts

Schm Ref.	PART NO.	Description		
C503	UP652470	C.POL	470pF	100V
C504	UP652470	C.POL	470pF	100V
C505	UP652470	C.POL	470pF	100V
C506	UP652470	C.POL	470pF	100V
C507	UP652470	C.POL	470pF	100V
C508	UP652470	C.POL	470pF	100V
C509	UP652470	C.POL	470pF	100V
C510	UP652470	C.POL	470pF	100V
C511	UP652470	C.POL	470pF	100V
C512	UP652470	C.POL	470pF	100V
C513	UU166100	C.EL	1uF	50V
C514	UP652220	C.POL	220pF	100V(ALG)
C515	UP652220	C.POL	220pF	100V
C516	UU118220	C.EL	220uF	6.3V
C517	UP652220	C.POL	220pF	100V(ALG)
C518	UP652220	C.POL	220pF	100V
C519	UU118220	C.EL	220uF	6.3V
C520	UU166100	C.EL	1uF	50V
C521	UP652470	C.POL	470pF	100V
C522	UP652470	C.POL	470pF	100V
C523	UU166470	C.EL	4.7uF	50V
C524	UP652470	C.POL	470pF	100V
C525	UP652470	C.POL	470pF	100V
C526	UU166470	C.EL	4.7uF	50V
C527	UU166470	C.EL	4.7uF	50V
C528	UP652470	C.POL	470pF	100V
C529	UP652470	C.POL	470pF	100V
C530	UU166220	C.EL	2.2uF	50V
C531	UP652470	C.POL	470pF	100V
C532	UP652470	C.POL	470pF	100V
C533	UU166220	C.EL	2.2uF	50V
C534	UU147100	C.EL	10uF	25V
C535	UA654390	C.MYLAR	0.039uF	50V
C536	UA654110	C.MYLAR	0.011uF	50V
C537	UA654390	C.MYLAR	0.039uF	50V
C538	UA654110	C.MYLAR	0.011uF	50V
C539	UU147100	C.EL	10uF	25V
C540	UU147100	C.EL	10uF	25V
C541	UU147100	C.EL	10uF	25V
C542	UU147100	C.EL	10uF	25V
C543	UU137470	C.EL	47uF	16V(UCRTAL)
C544	UU137470	C.EL	47uF	16V(UCRTAL)
C545	UU147100	C.EL	10uF	25V
C546	UU147100	C.EL	10uF	25V
C547	UA653100	C.MYLAR	1000pF	50V
C548	UU137470	C.EL	47uF	16V
C549	UU138100	C.EL	100uF	16V
C550	UU138100	C.EL	100uF	16V
C551	UA653100	C.MYLAR	1000pF	50V
C552	UU137470	C.EL	47uF	16V
C553	UU137470	C.EL	47uF	16V
C554	UU137470	C.EL	47uF	16V
C555	UU166100	C.EL	1uF	50V(UCRTAL)

\* New Parts

## P.C.B. FUNCTION

Schm Ref.	PART NO.	Description		
C556	UU137470	C.EL	47uF	16V
C557	UP652100	C.POL	100pF	100V(UCRTAL)
C558	UP652100	C.POL	100pF	100V(UCRTAL)
C559	UU137470	C.EL	47uF	16V
C560	UU166100	C.EL	1uF	50V(UCRTAL)
C561	UU147100	C.EL	10uF	25V
C562	UU166470	C.EL	4.7uF	50V
C563	UU166470	C.EL	4.7uF	50V
C564	UP652100	C.POL	100pF	100V
C565	UU166470	C.EL	4.7uF	50V
C566	UP652100	C.POL	100pF	100V
C567	UU166470	C.EL	4.7uF	50V
C568	UU147100	C.EL	10uF	25V
C569	UU147100	C.EL	10uF	25V(UCRTAL)
C570	UU147100	C.EL	10uF	25V(UCRTAL)
C571	UU166100	C.EL	1uF	50V(UCRTAL)
C572	UU137220	C.EL	22uF	16V
C573	UP654270	C.POL	0.027uF	100V
C574	UP654270	C.POL	0.027uF	100V
C575	UU137220	C.EL	22uF	16V
C577	UU147100	C.EL	10uF	25V
C579	UU147100	C.EL	10uF	25V
C582	US135100	C.CE.CHP	0.1uF	16V
C583	UP654270	C.POL	0.027uF	100V
C586	UP654270	C.POL	0.027uF	100V
C587	UU147100	C.EL	10uF	25V
C588	UU147100	C.EL	10uF	25V
C589	UU147100	C.EL	10uF	25V
C590	UU147100	C.EL	10uF	25V
C591	US135100	C.CE.CHP	0.1uF	16V
C592	UU166220	C.EL	2.2uF	50V(UCRTAL)
C593	UU147100	C.EL	10uF	25V
C594	UU147100	C.EL	10uF	25V
C595	UU137470	C.EL	47uF	16V
C596	UU137470	C.EL	47uF	16V
C597	UU147100	C.EL	10uF	25V
C598	UU147100	C.EL	10uF	25V
C599	UU147100	C.EL	10uF	25V
C600	UU147100	C.EL	10uF	25V
C601	US063100	C.CE.M.CHP	1000pF	50V
C602	US063100	C.CE.M.CHP	1000pF	50V
C603	US135100	C.CE.CHP	0.1uF	16V
C604	US135100	C.CE.CHP	0.1uF	16V
C605	US135100	C.CE.CHP	0.1uF	16V
C606	US135100	C.CE.CHP	0.1uF	16V
C607	UU119100	C.EL	1000uF	6.3V
C608	US135100	C.CE.CHP	0.1uF	16V
C609	UU137470	C.EL	47uF	16V
C610	US135100	C.CE.CHP	0.1uF	16V
C611	US135100	C.CE.CHP	0.1uF	16V
C612	US135100	C.CE.CHP	0.1uF	16V
C613	US135100	C.CE.CHP	0.1uF	16V
C614	US135100	C.CE.CHP	0.1uF	16V

\* New Parts

Schm Ref.	PART NO.	Description		
C615	US135100	C.CE.CHP	0.1uF	16V
C616	US135100	C.CE.CHP	0.1uF	16V
C617	US135100	C.CE.CHP	0.1uF	16V
C618	US063100	C.CE.M.CHP	1000pF	50V
C619	US135100	C.CE.CHP	0.1uF	16V
C620	US135100	C.CE.CHP	0.1uF	16V
C621	US135100	C.CE.CHP	0.1uF	16V
C622	US135100	C.CE.CHP	0.1uF	16V
C623	UU147100	C.EL	10uF	25V
C624	UU147100	C.EL	10uF	25V
C625	US135100	C.CE.CHP	0.1uF	16V
C626	US135100	C.CE.CHP	0.1uF	16V
C627	US135100	C.CE.CHP	0.1uF	16V
C628	US135100	C.CE.CHP	0.1uF	16V
C629	UU147100	C.EL	10uF	25V
C630	US135100	C.CE.CHP	0.1uF	16V
C631	US135100	C.CE.CHP	0.1uF	16V
C632	US135100	C.CE.CHP	0.1uF	16V
C633	UU165470	C.EL	0.47uF	50V
C634	US135100	C.CE.CHP	0.1uF	16V
C635	UP652100	C.POL	100pF	100V
C636	UP652100	C.POL	100pF	100V
C637	UU147100	C.EL	10uF	25V
C638	UU147100	C.EL	10uF	25V
C639	UU147100	C.EL	10uF	25V
C640	UU147100	C.EL	10uF	25V
C641	UU147100	C.EL	10uF	25V
C642	UP652100	C.POL	100pF	100V
C643	UP652100	C.POL	100pF	100V
C644	US135100	C.CE.CHP	0.1uF	16V
C645	UU137470	C.EL	47uF	16V
C646	UU147100	C.EL	10uF	25V
C647	US135100	C.CE.CHP	0.1uF	16V
C648	UU137470	C.EL	47uF	16V
C649	UU137470	C.EL	47uF	16V
C650	UU137470	C.EL	47uF	16V
C651	UU137470	C.EL	47uF	16V
C652	UP652100	C.POL	100pF	100V
C653	UP652100	C.POL	100pF	100V
C654	UU147100	C.EL	10uF	25V
C655	UU118100	C.EL	100uF	6.3V
C656	UU147100	C.EL	10uF	25V
C657	UU147100	C.EL	10uF	25V
C658	UU118100	C.EL	100uF	6.3V
C659	US135100	C.CE.CHP	0.1uF	16V
C660	UU119100	C.EL	1000uF	6.3V
C661	UU119100	C.EL	1000uF	6.3V
C662	VT740700	C.EL	4700uF	5.5V
C663	US135100	C.CE.CHP	0.1uF	16V
C664	UU119100	C.EL	1000uF	6.3V
C665	UU137470	C.EL	47uF	16V
C666	UU137470	C.EL	47uF	16V
C667	UU137470	C.EL	47uF	16V

\* New Parts

P.C.B. FUNCTION

Schm Ref.	PART NO.	Description		
C668	UU137470	C. EL	47uF	16V
C669	UP652100	C. POL	100pF	100V
C671	US135100	C. CE. CHP	0.1uF	16V
C673	US135100	C. CE. CHP	0.1uF	16V
C674	US135100	C. CE. CHP	0.1uF	16V
C675	UU147100	C. EL	10uF	25V
C676	UU147100	C. EL	10uF	25V
C677	UU166220	C. EL	2.2uF	50V
C678	UU166220	C. EL	2.2uF	50V
C679	UU166220	C. EL	2.2uF	50V
C680	UU166220	C. EL	2.2uF	50V
C681	UU166220	C. EL	2.2uF	50V
C682	UU147100	C. EL	10uF	25V
C683	US063100	C. CE. M. CHP	1000pF	50V
C684	US063100	C. CE. M. CHP	1000pF	50V
C685	US135100	C. CE. CHP	0.1uF	16V
C686	US135100	C. CE. CHP	0.1uF	16V
C687	US135100	C. CE. CHP	0.1uF	16V
C688	US135100	C. CE. CHP	0.1uF	16V
C689	UU147100	C. EL	10uF	25V
C692	VD930900	C. CE. SMI	0.1uF	25V
C693	US135100	C. CE. CHP	0.1uF	16V
C694	US135100	C. CE. CHP	0.1uF	16V
C695	US135100	C. CE. CHP	0.1uF	16V
C696	US135100	C. CE. CHP	0.1uF	16V
C697	UU149100	C. EL	1000uF	25V
D501	VG437400	DIODE. ZENR	MTZJ5.1B(UCRTAL)	
D502	VT332900	DIODE	1SS355	
D503	VG438100	DIODE. ZENR	MTZJ6.2C(RT)	
D503	VG438200	DIODE. ZENR	MTZJ6.8A(UCALG)	
D504	VV220700	DIODE. SHOT	RB501V-40	
D505	VV220700	DIODE. SHOT	RB501V-40	
D506	VV220700	DIODE. SHOT	RB501V-40	
D507	VV220700	DIODE. SHOT	RB501V-40	
D508	VT332900	DIODE	1SS355	
D509	iF004600	DIODE	1SS133	
D510	VT332900	DIODE	1SS355	
D511	VG437700	DIODE. ZENR	MTZJ5.6B	5.6V
D512	VG437700	DIODE. ZENR	MTZJ5.6B	5.6V
D513	VT332900	DIODE	1SS355	
D514	iF004600	DIODE	1SS133	
D515	iF004600	DIODE	1SS133	
D516	VG437300	DIODE. ZENR	MTZJ5.1A	5.1V
D517	VG437300	DIODE. ZENR	MTZJ5.1A	5.1V
D518	VT332900	DIODE	1SS355	
IC501	XJ553A00	IC	NJM2068MD	
IC502	XP895A00	IC	LC78212	
IC503	XP894A00	IC	LC78211	
IC504	XP895A00	IC	LC78212	
IC505	XP896A00	IC	LC78213	
IC506	XF291A00	IC	uPC4570G2	
IC507	XF291A00	IC	uPC4570G2	
IC508	XF291A00	IC	uPC4570G2	

\* New Parts

Schm Ref.	PART NO.	Description		
IC509	XF291A00	IC	uPC4570G2(UCRTAL)	
IC510	XS884A00	IC	LC7536Y(UCRTAL)	
IC511	XF291A00	IC	uPC4570G2	
IC512	XP894A00	IC	LC78211	
IC513	XF291A00	IC	uPC4570G2	
IC514	XF291A00	IC	uPC4570G2	
IC515	XF291A00	IC	uPC4570G2	
IC516	XW173A00	IC	CS3310-KS	
IC517	XW173A00	IC	CS3310-KS	
IC518	XW173A00	IC	CS3310-KS	
IC519	XW173A00	IC	CS3310-KS	
IC520	XW173A00	IC	CS3310-KS	
IC521	XF291A00	IC	uPC4570G2	
IC522	XP896A00	IC	LC78213	
IC523	XF291A00	IC	uPC4570G2	
IC524	XF291A00	IC	uPC4570G2	
IC525	XF291A00	IC	uPC4570G2	
IC526	XY892A00	IC.CPU	M30802SGP CPU	
IC527	XZ450B00	IC	MBM29F400BC-70	
IC528	XJ604A00	IC	NJM78M05FA	
PJ501	V3855600	JACK.PIN	4P	
PJ502	V3855600	JACK.PIN	4P	
PJ503	V4198900	JACK.PIN	4P	LPR6520-B71
PJ504	V4199200	JACK.PIN	6P	
PN501	V3750200	PIN	L=70	
PN502	V3750200	PIN	L=70	
PN503	V3750200	PIN	L=70	
Q501	VD303700	TR	2SC3326(UCRTAL)	
Q502	VD303700	TR	2SC3326(UCRTAL)	
Q503	VV556500	TR	2SA1037K(UCRTAL)	
Q504	VV556500	TR	2SA1037K(UCRTAL)	
Q504	VV556500	TR	2SA1037K Q,R,S	
Q505	VV556400	TR	2SC2412K Q,R,S	
Q506	VV556500	TR	2SA1037K Q,R,S	
Q507	VV655700	TR.DGT	DTC144EKA	
Q508	VP872700	TR	2SC4488 S,T	
Q509	VP872600	TR	2SA1708 S,T	
Q510	VD303700	TR	2SC3326 A,B	
Q511	VV556500	TR	2SA1037K Q,R,S	
Q512	VD303700	TR	2SC3326 A,B	
Q513	VV556500	TR	2SA1037K Q,R,S	
Q514	VD303700	TR	2SC3326 A,B	
Q515	VD303700	TR	2SC3326 A,B	
Q516	VD303700	TR	2SC3326 A,B	
Q517	VD303700	TR	2SC3326 A,B	
Q518	VD303700	TR	2SC3326 A,B	
Q519	VD303700	TR	2SC3326 A,B	
Q520	VD303700	TR	2SC3326 A,B	
Q521	VD303700	TR	2SC3326 A,B	
Q522	VD303700	TR	2SC3326 A,B	
Q523	VD303700	TR	2SC3326 A,B	
Q524	VD303700	TR	2SC3326 A,B	
Q525	VV556500	TR	2SA1037K Q,R,S	

\* New Parts

**P.C.B. FUNCTION & VIDEO**

Schm Ref.	PART NO.	Description
Q526	VV556500	TR 2SA1037K Q, R, S
Q527	VV556500	TR 2SA1037K Q, R, S
Q528	VV556500	TR 2SA1037K Q, R, S
Q529	VV556500	TR 2SA1037K Q, R, S
Q530	VV556500	TR 2SA1037K Q, R, S
Q531	VV556500	TR 2SA1037K Q, R, S
Q532	VV556500	TR 2SA1037K Q, R, S
Q533	VV556500	TR 2SA1037K Q, R, S
Q534	VV556500	TR 2SA1037K Q, R, S
Q535	VV556500	TR 2SA1037K Q, R, S
Q536	VV556500	TR 2SA1037K Q, R, S
Q537	VD303700	TR 2SC3326 A, B
Q538	VD303700	TR 2SC3326 A, B
Q539	VD303700	TR 2SC3326 A, B
Q540	VD303700	TR 2SC3326 A, B
Q541	VD303700	TR 2SC3326 A, B
Q542	VD303700	TR 2SC3326 A, B
Q543	VD303700	TR 2SC3326 A, B
Q544	VD303700	TR 2SC3326 A, B
Q545	VD303700	TR 2SC3326 A, B
R565	HV455100	R. CAR. FP 100 1/4W
R568	HV455100	R. CAR. FP 100 1/4W
R601	HV453220	R. CAR. FP 2.2 1/4W
R635	HV453220	R. CAR. FP 2.2 1/4W
R648	HV454100	R. CAR. FP 10 1/4W
R719	HV453220	R. CAR. FP 2.2 1/4W
R720	HV453220	R. CAR. FP 2.2 1/4W
R822	HV453220	R. CAR. FP 2.2 1/4W
R842	HV453220	R. CAR. FP 2.2 1/4W
ST501	BB071360	SCR. TERM 8. 3x13
XL501	VT630600	RSNR. CE 16MHz CST
*	V6606000	P. C. B. VIDEO(UCRT)
*	V6606100	P. C. B. VIDEO(AL)
*	V6606200	P. C. B. VIDEO(G)
CB551	VQ961400	CN. BS. PIN 11P
CB552	VQ961400	CN. BS. PIN 11P
CB561	VQ963200	CN. BS. PIN 11P
CB562	VQ963200	CN. BS. PIN 11P
CB563	VQ961400	CN. BS. PIN 11P
CB564	VQ961400	CN. BS. PIN 11P
CB601	VM929900	CN. BS. PIN 15P
CB602	VN066500	CN. BS. PIN 12P
CB701	VM929900	CN. BS. PIN 15P
CB702	LB919030	CN. BS. PIN 3P
CB751	VB858300	CN. BS. PIN 4P
CB752	VM859600	CN. BS. PIN 15P
CB951	V3768800	SOCKET 17LE-23090-28
CB952	VQ044500	CN. BS. PIN 11P
C551	UP652470	C. POL 470pF 100V
C552	UP652470	C. POL 470pF 100V

\* New Parts

Schm Ref.	PART NO.	Description
C553	UP652470	C. POL 470pF 100V
C554	UP652470	C. POL 470pF 100V
C555	UP652470	C. POL 470pF 100V
C556	UP652470	C. POL 470pF 100V
C557	UP652470	C. POL 470pF 100V
C558	UP652470	C. POL 470pF 100V
C559	UP652470	C. POL 470pF 100V
C560	UP652470	C. POL 470pF 100V
C561	UP652470	C. POL 470pF 100V
C562	UP652470	C. POL 470pF 100V
C563	UP652470	C. POL 470pF 100V
C564	UP652470	C. POL 470pF 100V
C565	UP652470	C. POL 470pF 100V
C566	UP652470	C. POL 470pF 100V
C567	UP652470	C. POL 470pF 100V(UCRTAL)
C568	UP652470	C. POL 470pF 100V(UCRTAL)
C601	US062100	C. CE. M. CHP 100pF 50V
C602	US062100	C. CE. M. CHP 100pF 50V
C603	US062100	C. CE. M. CHP 100pF 50V
C604	US062100	C. CE. M. CHP 100pF 50V
C605	US062100	C. CE. M. CHP 100pF 50V
C606	US062100	C. CE. M. CHP 100pF 50V
C607	US135100	C. CE. CHP 0.1uF 16V
C608	US135100	C. CE. CHP 0.1uF 16V
C609	US135100	C. CE. CHP 0.1uF 16V
C610	UR829100	C. EL 1000uF 10V
C611	VJ837200	C. EL 47uF 16V
C612	VJ837200	C. EL 47uF 16V
C613	VJ837200	C. EL 47uF 16V
C614	US135100	C. CE. CHP 0.1uF 16V
C616	US135100	C. CE. CHP 0.1uF 16V
C617	UR827470	C. EL 47uF 10V
C618	VJ837200	C. EL 47uF 16V
C619	US062820	C. CE. CHP 820pF 50V(ALG)
C619	US063150	C. CE. M. CHP 1500pF 50V(UCRT)
C620	US062270	C. CE. M. CHP 270pF 50V(ALG)
C620	US062390	390P 50V(UCRT)
C621	UR827470	C. EL 47uF 10V
C622	UR827470	C. EL 47uF 10V
C623	UR827470	C. EL 47uF 10V
C624	UR827470	C. EL 47uF 10V
C625	UR847100	C. EL 10uF 25V
C626	US135100	C. CE. CHP 0.1uF 16V
C627	US135100	C. CE. CHP 0.1uF 16V
C628	US135100	C. CE. CHP 0.1uF 16V
C629	US135100	C. CE. CHP 0.1uF 16V
C630	US060800	8pF 50V
C631	UR827470	C. EL 47uF 10V
C632	UR827470	C. EL 47uF 10V
C633	US061330	C. CE. M. CHP 33pF 50V
C634	US064100	C. CE. M. CHP 0.01uF 50V
C635	UR827470	C. EL 47uF 10V
C636	UM416470	C. EL 4.7uF 50V

\* New Parts

P.C.B. VIDEO

Schm Ref.	PART NO.	Description
C637	UM416470	C. EL 4.7uF 50V
C638	US135100	C. CE. CHP 0.1uF 16V
C639	US063120	C. CE. M. CHP 1200pF 50V
C640	US062470	C. CE. M. CHP 470pF 50V
C641	VJ839100	C. EL 1uF 50V
C642	VJ839100	C. EL 1uF 50V
C643	US060700	C. CE. CHP 7pF 50V
C644	US061240	C. CE. CHP 24pF 50V
C645	US061240	C. CE. CHP 24pF 50V
C646	US062220	C. CE. CHP 220pF 50V
C647	US062120	C. CE. CHP 120pF 50V
C648	UR827470	C. EL 47uF 10V
C649	US135100	C. CE. CHP 0.1uF 16V
C650	US135100	C. CE. CHP 0.1uF 16V
C651	UR847100	C. EL 10uF 25V
C652	US135100	C. CE. CHP 0.1uF 16V
C701	US062100	C. CE. M. CHP 100pF 50V
C702	US062100	C. CE. M. CHP 100pF 50V
C703	US062100	C. CE. M. CHP 100pF 50V
C704	US062100	C. CE. M. CHP 100pF 50V(UCRTAL)
C705	UR847100	C. EL 10uF 25V
C706	UR829100	C. EL 1000uF 10V
C707	UR827470	C. EL 47uF 10V
C708	UR827470	C. EL 47uF 10V
C709	UR827470	C. EL 47uF 10V
C710	UR827470	C. EL 47uF 10V
C711	UR827470	C. EL 47uF 10V(UCRTAL)
C712	US135220	C. CE. CHP 0.22uF 16V
C713	UR827470	C. EL 47uF 10V
C714	UR827470	C. EL 47uF 10V
C715	US135100	C. CE. CHP 0.1uF 16V
C716	US135100	C. CE. CHP 0.1uF 16V
C717	VF760000	C. EL 100uF 10V
C718	VJ837200	C. EL 47uF 16V
C719	US135100	C. CE. CHP 0.1uF 16V
C720	US135100	C. CE. CHP 0.1uF 16V
C721	US135100	C. CE. CHP 0.1uF 16V
C722	US135100	C. CE. CHP 0.1uF 16V
C751	VF466800	C. CE. TUBLR 100pF 50V
C752	VF466800	C. CE. TUBLR 100pF 50V
C753	VF466800	C. CE. TUBLR 100pF 50V
C757	UP652470	C. POL 470pF 100V
C758	UP652470	C. POL 470pF 100V
C759	UP652470	C. POL 470pF 100V
C760	UP652470	C. POL 470pF 100V
C761	VR169200	C. MYLAR. ML ECQ-V1H474JL3
C762	UP652470	C. POL 470pF 100V
C763	UP652470	C. POL 470pF 100V
C764	UP652100	C. POL 100pF 100V
C765	UP652100	C. POL 100pF 100V
C766	UP652100	C. POL 100pF 100V
C767	UP652100	C. POL 100pF 100V
C768	US064100	C. CE. M. CHP 0.01uF 50V

\* New Parts

Schm Ref.	PART NO.	Description
C769	US064100	C. CE. M. CHP 0.01uF 50V
C770	US064100	C. CE. M. CHP 0.01uF 50V
C771	US135100	C. CE. CHP 0.1uF 16V
C772	US135100	C. CE. CHP 0.1uF 16V
C773	UR847100	C. EL 10uF 25V
C774	UR847100	C. EL 10uF 25V
C951	VF760000	C. EL 100uF 10V
C952	US135100	C. CE. CHP 0.1uF 16V
C953	US135100	C. CE. CHP 0.1uF 16V
C954	US135100	C. CE. CHP 0.1uF 16V
C955	US135100	C. CE. CHP 0.1uF 16V
C956	US135100	C. CE. CHP 0.1uF 16V
C957	US135100	C. CE. CHP 0.1uF 16V
D601	iF004600	DIODE 1SS133
D602	iF004600	DIODE 1SS133
D603	iF004600	DIODE 1SS133
D604	iF004600	DIODE 1SS133
D605	iF004600	DIODE 1SS133
D606	iF004600	DIODE 1SS133
D607	iF004600	DIODE 1SS133
D608	iF004600	DIODE 1SS133
D609	iF004600	DIODE 1SS133
D610	iF004600	DIODE 1SS133
D951	iF004600	DIODE 1SS133(UCRTAL)
IC601	XW939A00	IC TK15420M VIDEO AMP
IC602	XL493A00	IC TC74HC4051AP
IC603	XL493A00	IC TC74HC4051AP
IC604	XL493A00	IC TC74HC4051AP
IC605	XL493A00	IC TC74HC4051AP
IC606	iR405300	IC TC74HC4053AP(UCRTAL)
IC607	iR405300	IC TC74HC4053AP
IC608	iG142200	IC TC74HCU04AP
IC609	XY443A00	IC LA7109 6CH
IC610	XZ060A00	IC LC74781-9798
IC611	XW416A00	IC BU2092 SER/PAR
IC701	XW911A00	IC LA7108M VIDEO AMP
IC702	XL493A00	IC TC74HC4051AP
IC703	XL493A00	IC TC74HC4051AP
IC704	iR405300	IC TC74HC4053AP(UCRTAL)
IC704	iR405300	IC TC74HC4053AP
IC751	XZ177A00	IC LA7104M VIDEO AMP
IC752	iR405300	IC TC74HC4053AP
* IC951	XZ617A00	IC HIN202ECBN-T
JK601	VP113600	CN. DIN 2P
JK602	VP113600	CN. DIN 2P
JK603	VP113600	CN. DIN 2P
JK604	VP113600	CN. DIN 2P
JK605	VQ960400	CN. DIN 1P(G)
JK606	VQ960400	CN. DIN 1P(UCRTAL)
JK951	VJ726800	JACK. MNI (UCRTAL)
JK952	VJ726800	JACK. MNI (UCRTAL)
JK953	VJ726800	JACK. MNI (UCRTAL)
L602	V3233700	COIL 1.5uH

\* New Parts



## P.C.B. VIDEO &amp; OPERATION

Schm Ref.	PART NO.	Description	
L603	V6236000	COIL	4.7uH LAV35VB4R7K
L605	V2726100	COIL	33uH
PJ551	V3855600	JACK.PIN	4P
PJ552	V3855600	JACK.PIN	4P
PJ553	V3855600	JACK.PIN	4P
PJ554	V3855600	JACK.PIN	4P(G)
* PJ554	V3856100	JACK.PIN	6P(UCRTAL)
PJ701	VN134600	JACK.PIN	1P
PJ702	VR110100	JACK.PIN	2P
PJ703	VR110100	JACK.PIN	2P
PJ704	VR110100	JACK.PIN	2P
PJ705	VJ695900	JACK.PIN	3P(UCRTAL)
PJ705	VR110100	JACK.PIN	2P(G)
* PJ751	V6236200	JACK.PIN	3P YKC21-4144
* PJ752	V6236200	JACK.PIN	3P YKC21-4144
* PJ753	V6236200	JACK.PIN	3P YKC21-4144
PJ754	VM725900	JACK.PIN	4P
PJ755	VJ249500	JACK.PIN	4P
* PJ756	V6360700	JACK.PIN	RED/WH LPR6521-341
PJ757	VZ668100	JACK.PIN	2P
PN601	V3750100	PIN	L=50
Q601	iC174020	TR	2SC1740S R,S
Q602	iC287820	TR	2SC2878 A,B
Q603	VD678700	TR.DGT	DTC114ES
Q604	iC174020	TR	2SC1740S R,S
Q605	iC174020	TR	2SC1740S R,S
Q606	iA101521	TR	2SA1015 Y
Q607	iC224030	TR	2SC2240 GR,BL
Q608	iC053540	TR	2SC535 A,B,C
Q609	iC287820	TR	2SC2878 A,B(G)
Q701	iC174020	TR	2SC1740S R,S
R958	HL315100	R.MTL.OXD	100 1W
R958	HL315100	R.MTL.OXD	100 1W(UCRTAL)
ST951	BB071360	SCR.TERM	8.3x13
XL601	VV949800	RSNR.CRYS	14.31818MHz(UCRT)
XL601	VV949900	RSNR.CRYS	17.734475MHz(ALG)
*	V6601000	P.C.B.	OPERATION(UCRALT)
*	V6601100	P.C.B.	OPERATION(G)
CB801	VQ044900	CN.BS.PIN	19P
CB802	VQ960800	CN.BS.PIN	5P
CB831	VQ962600	CN.BS.PIN	5P
CB901	VB858200	CN.BS.PIN	3P
CB902	VF982200	CN.BS.PIN	14P
CB935	V5478200	CN.PHOT.SN	1P GP1FA551RZ
CB936	VB858200	CN.BS.PIN	3P
C801	UU137470	C.EL	47uF 16V
C802	UU137470	C.EL	47uF 16V
C803	UU147220	C.EL	22uF 25V
C804	UU147220	C.EL	22uF 25V
C805	UU165100	C.EL	0.1uF 50V

\* New Parts

Schm Ref.	PART NO.	Description	
C806	UU165100	C.EL	0.1uF 50V
C807	UU165100	C.EL	0.1uF 50V
C808	UU165100	C.EL	0.1uF 50V
C809	UU166100	C.EL	1uF 50V
C810	UU166100	C.EL	1uF 50V
C811	UU166220	C.EL	2.2uF 50V
C812	UU166220	C.EL	2.2uF 50V
C813	UP652100	C.POL	100pF 100V
C814	UP652100	C.POL	100pF 100V
C815	UU137470	C.EL	47uF 16V
C816	UU137470	C.EL	47uF 16V
* C817	VR168400	C.MYLAR.ML	ECQ-V1H124JL3
* C818	VR168400	C.MYLAR.ML	ECQ-V1H124JL3
C819	UA654330	C.MYLAR	0.033uF 50V
C820	UA654330	C.MYLAR	0.033uF 50V
C821	UU147100	C.EL	10uF 25V
C822	UU147100	C.EL	10uF 25V
C823	UU137470	C.EL	47uF 16V
C824	UU137470	C.EL	47uF 16V
C825	UU147100	C.EL	10uF 25V
C826	UU147100	C.EL	10uF 25V
C827	FG212100	C.CE	100pF 50V
C828	FG212100	C.CE	100pF 50V
C829	FG212100	C.CE	100pF 50V
C830	FG212100	C.CE	100pF 50V
C831	UU137470	C.EL	47uF 16V
C832	UU137470	C.EL	47uF 16V
C833	FG251220	C.CE	22pF 50V
C834	FG251220	C.CE	22pF 50V
C835	UU139100	C.EL	1000uF 16V
C836	UU139100	C.EL	1000uF 16V
* C837	VR168400	C.MYLAR.ML	ECQ-V1H124JL3
* C838	VR168400	C.MYLAR.ML	ECQ-V1H124JL3
C891	VF467000	C.CE.TUBLR	1000pF 50V
C892	VF467000	C.CE.TUBLR	1000pF 50V
C893	VF467000	C.CE.TUBLR	1000pF 50V
C894	VJ599100	C.CE.TUBLR	0.1uF 50V
C901	VJ599100	C.CE.TUBLR	0.1uF 50V
C902	VJ599100	C.CE.TUBLR	0.1uF 50V
C903	VJ599100	C.CE.TUBLR	0.1uF 50V
C904	VJ599100	C.CE.TUBLR	0.1uF 50V
C905	VJ599100	C.CE.TUBLR	0.1uF 50V
C906	VJ599100	C.CE.TUBLR	0.1uF 50V
C907	VJ599100	C.CE.TUBLR	0.1uF 50V
C908	US135100	C.CE.CHP	0.1uF 16V
C909	UU137100	C.EL	10uF 16V
C910	US135100	C.CE.CHP	0.1uF 16V
C911	VJ599100	C.CE.TUBLR	0.1uF 50V
C912	VJ599100	C.CE.TUBLR	0.1uF 50V
C913	VJ599100	C.CE.TUBLR	0.1uF 50V
C914	VJ599100	C.CE.TUBLR	0.1uF 50V
C915	US135100	C.CE.CHP	0.1uF 16V
C916	VJ599100	C.CE.TUBLR	0.1uF 50V

\* New Parts

P.C.B. OPERATION

Schm Ref.	PART NO.	Description		
C917	VJ599100	C. CE . TUBLR	0.1uF	50V
C918	VJ599100	C. CE . TUBLR	0.1uF	50V
C919	UU167100	C. EL	10uF	50V
C920	VJ599100	C. CE . TUBLR	0.1uF	50V
* C921	UU118330	C. EL	330uF	6.3V
C922	US135100	C. CE . CHP	0.1uF	16V
C923	US062100	C. CE . M. CHP	100pF	50V
C924	US135100	C. CE . CHP	0.1uF	16V
C925	VJ599100	C. CE . TUBLR	0.1uF	50V
C926	VJ599100	C. CE . TUBLR	0.1uF	50V
C927	US060700	C. CE . CHP	7pF	50V
C935	US135100	C. CE . CHP	0.1uF	16V
C937	US135100	C. CE . CHP	0.1uF	16V
C938	US062100	C. CE . M. CHP	100pF	50V
C939	US062100	C. CE . M. CHP	100pF	50V
C940	US135100	C. CE . CHP	0.1uF	16V
C941	US135100	C. CE . CHP	0.1uF	16V
D801	VG439100	DIODE . ZENR	MTZJ9.1A	9.1V
D802	VG439100	DIODE . ZENR	MTZJ9.1A	9.1V
D803	VU264100	DIODE	1SR139-400	
D804	VU264100	DIODE	1SR139-400	
* D901	VG438300	DIODE . ZENR	MTZJ6.8B	6.8V
D902	V2598200	LED	S1R-505ST (UCRALT)	
IC801	iG001270	IC	TC4066BP	
IC802	XM356A00	IC	NJM2068LD	
IC803	XB247301	IC	uPC4570HA	
IC804	XP844A00	IC	NJM4556AL	
* IC901	XY115A00	IC	M66004MAFP-200C	
* IC902	XY115A00	IC	M66004MAFP-200C	
* JK831	V4164400	JACK . PHONE	YKB21-5209	
JK935	V2589500	CN	1P	
L935	V2726500	COIL	68uH	
PJ935	VS868400	JACK . PIN	3P	
Q801	VG721700	TR . DGT	DTA144ES	
Q802	VG722000	TR . DGT	DTC144ES	
Q803	VK432900	TR	2SD1915F S,T	
Q804	VK432900	TR	2SD1915F S,T	
Q901	VV556400	TR	2SC2412K Q,R,S	
Q902	VV556400	TR	2SC2412K Q,R,S	
Q903	VV556400	TR	2SC2412K Q,R,S	
Q904	VV556400	TR	2SC2412K Q,R,S	
Q905	VV556400	TR	2SC2412K Q,R,S	
Q906	VV556400	TR	2SC2412K Q,R,S	
Q907	VV556400	TR	2SC2412K Q,R,S	
Q908	VV556400	TR	2SC2412K Q,R,S	
Q909	VV556400	TR	2SC2412K Q,R,S	
Q910	VV556400	TR	2SC2412K Q,R,S	
Q911	VV556400	TR	2SC2412K Q,R,S	
Q935	VV556400	TR	2SC2412K Q,R,S	
Q936	VV556500	TR	2SA1037K Q,R,S	
R803	HV453330	R. CAR . FP	3.3	1/4W
R804	HV453330	R. CAR . FP	3.3	1/4W
R839	HV455100	R. CAR . FP	100	1/4W

\* New Parts

Schm Ref.	PART NO.	Description		
R840	HV455100	R. CAR . FP	100	1/4W
R841	HV455220	R. CAR . FP	220	1/4W
R842	HV455220	R. CAR . FP	220	1/4W
* R846	VP439800	R. MTL . FLM	2.2K	1/4W F
* R847	VP439800	R. MTL . FLM	2.2K	1/4W F
* R848	VP439800	R. MTL . FLM	2.2K	1/4W F
* R849	VP439800	R. MTL . FLM	2.2K	1/4W F
R850	VP441600	R. MTL . FLM	12K	1/4W
R851	VP441600	R. MTL . FLM	12K	1/4W
R852	VP441600	R. MTL . FLM	12K	1/4W
* R853	VP442300	R. MTL . FLM	24K	1/4W F
* R854	VP442300	R. MTL . FLM	24K	1/4W F
* R855	VP442300	R. MTL . FLM	24K	1/4W F
* R856	VP442300	R. MTL . FLM	24K	1/4W F
* R857	VP442300	R. MTL . FLM	24K	1/4W F
ST891	BB071360	SCR . TERM	8.3x13	
* ST901	VP750600	SCR . TERM	MEP1700	
ST935	BB071360	SCR . TERM	8.3x13	
* SW801	V6217400	SW. RT. ENC	REB161PHD20FHINA1	
* SW802	V6154100	SW. RT. ENC	SDB161PH20FS-1-13	
* SW901	V4757100	SW. TACT	EVQ11A	
* SW902	V4757100	SW. TACT	EVQ11A	
* SW903	V4757100	SW. TACT	EVQ11A	
* SW971	V4757100	SW. TACT	EVQ11A	
* SW972	V4757100	SW. TACT	EVQ11A	
* SW973	V4757100	SW. TACT	EVQ11A	
* SW974	V4757100	SW. TACT	EVQ11A	
* SW975	V4757100	SW. TACT	EVQ11A	
* SW976	V4757100	SW. TACT	EVQ11A	
* SW977	V4757100	SW. TACT	EVQ11A	
* SW978	V4757100	SW. TACT	EVQ11A(G)	
* SW979	V4757100	SW. TACT	EVQ11A(G)	
SW980	V4757100	SW. TACT	EVQ11A(G)	
SW981	V4757100	SW. TACT	EVQ11A(G)	
SW985	V6886700	SW. RT. ENC		
SW990	V4757100	SW. TACT	EVQ11A	
SW991	V4757100	SW. TACT	EVQ11A	
SW992	V4757100	SW. TACT	EVQ11A	
SW993	V4757100	SW. TACT	EVQ11A	
SW994	V4757100	SW. TACT	EVQ11A	
U901	VZ411100	L. DTCT	GP1U281X	
* V901	V6291200	FL. DSPLY	32-BT-07G	
VR801	VP741800	VR	B20K	
VR802	VP741900	VR	G25K	
* V6006800		SHEET		
VZ628400		SUPRT		

\* New Parts



RX-V3000/RX-V3000RDS

EXPLODED VIEW

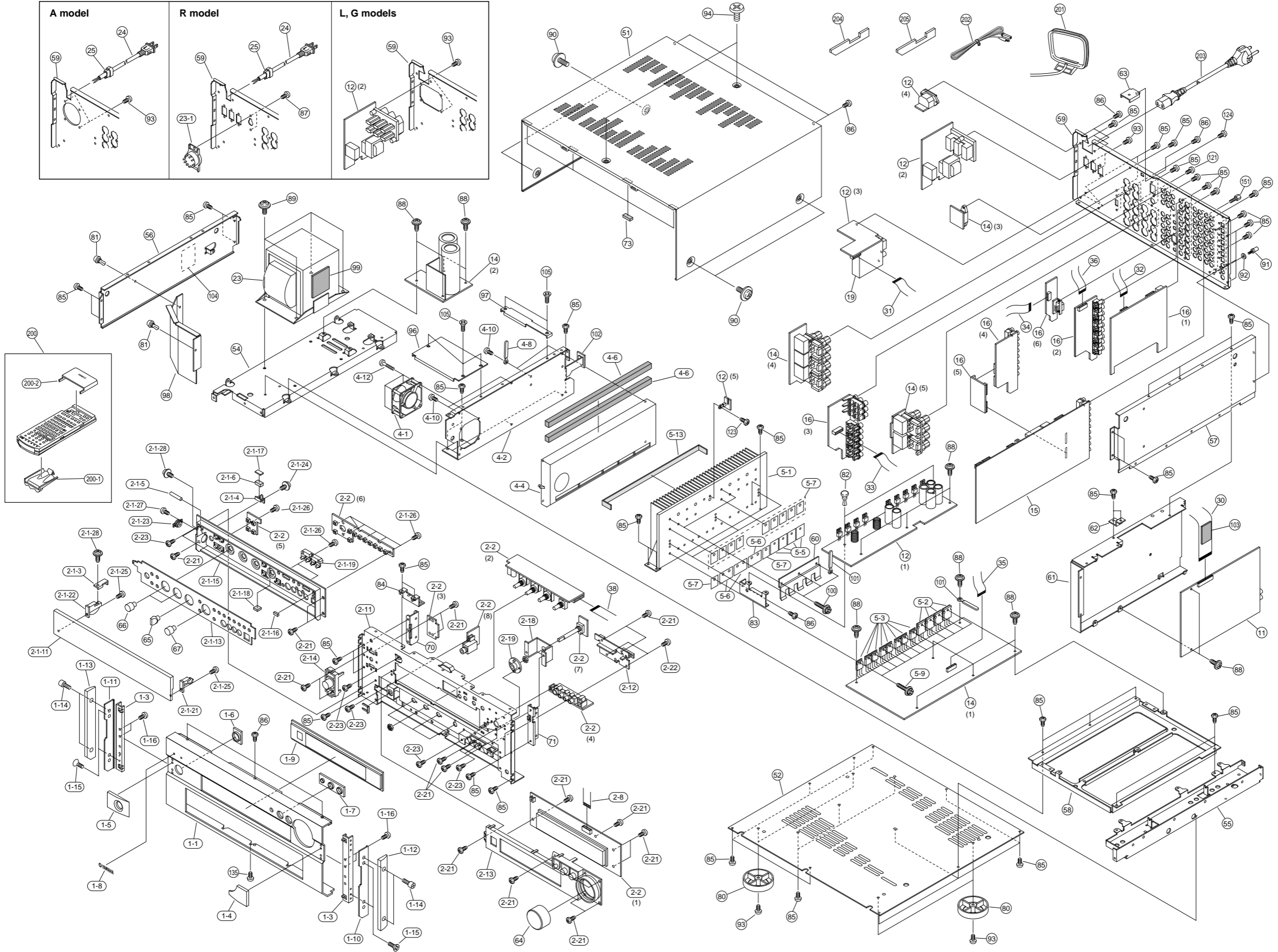
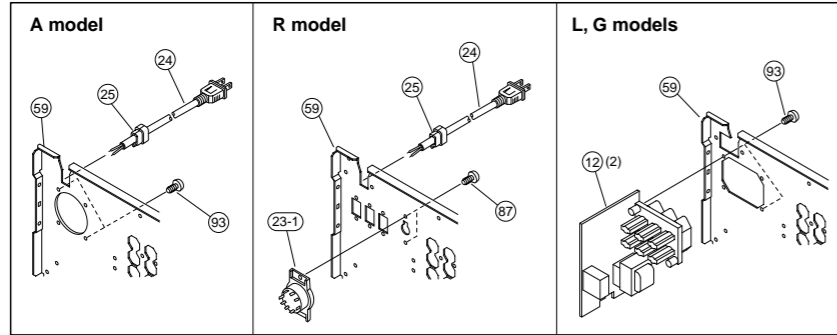

MECHANICAL PARTS

Ref. No.	PART NO.	Description	Remarks	Markets
* 1-1	V6065900	FRONT PANEL	RX-V3000GD	
* 1-1	V6076600	FRONT PANEL	RX-V3000RDSBL	
* 1-1	V6065800	FRONT PANEL	RX-V3000BL	
* 1-3	V6065300	SUPPORT/ESC		
* 1-4	V6066900	ESCUTCHEON/SIDE	R	BL
* 1-4	V6067000	ESCUTCHEON/SIDE	R	GD
* 1-5	V6067100	ESCUTCHEON/SIDE	L	BL
* 1-5	V6067200	ESCUTCHEON/SIDE	L	GD
* 1-6	V6070200	ESCUTCHEON/POWER		
* 1-7	V6070400	ESCUTCHEON, SEL		
* 1-8	V6004800	EMBLEM		BL
* 1-8	V6004900	EMBLEM		GD
* 1-9	V6070000	WINDOW PANEL, LID		
* 1-10	V6070800	SPACER/SIDE		
* 1-11	V6070900	SPACER/SIDE		
* 1-12	V6066600	PANEL/SIDE R		GD
* 1-12	V6066500	PANEL/SIDE R		BL
* 1-13	V6066700	PANEL/SIDE L		BL
* 1-13	V6066800	PANEL/SIDE L		GD
1-14	V4656300	SPECIAL SCREW	4-7 MFZN2-BL	
1-14	V4656500	SPECIAL SCREW	4-7 MFN133	
1-15	V6893800	FLAT HEAD B-TITE SCREW	2.6x8 MFZN2-BL	
1-16	ED330066	BIND HEAD SCREW	3x6 FCRM3-BL	
2-1-3	VZ619800	SUPPORT	HINGE	
2-1-4	VZ830500	SUPPORT	MG	
2-1-5	VZ621800	SHAFT	AA	
2-1-6	VZ621900	MAGNET		
* 2-1-11	V6066400	PANEL, LID		GD
* 2-1-11	V6066300	PANEL, LID		BL
* 2-1-13	V6067400	PLATE, SP	RX-V3000GD	
* 2-1-13	V6067500	PLATE, SP	RX-V3000RDSBL	G
* 2-1-13	V6067300	PLATE, SP	RX-V3000BL	UCRAT
* 2-1-15	V6068400	SUB PANEL CASE		BL
* 2-1-15	V6068500	SUB PANEL CASE		GD
2-1-16	V2048500	CUSHION, LID		GD
2-1-16	VT062900	CUSHION, LID		BL
2-1-17	V6996800	SPACER/MG		
2-1-18	VH625500	DAMPER		
* 2-1-19	V6069400	BUTTON/TU		BL
* 2-1-19	V6069600	BUTTON/TU		GD
2-1-21	V0050300	STOPPER	HINGE	GD
2-1-21	VJ888100	STOPPER	HINGE	BL
2-1-22	VZ629400	HINGE	MG	BL
2-1-22	V0047400	HINGE	MG	GD
2-1-23	VZ830300	DAMPER, GEAR	15G	
2-1-24	VQ541700	PW HEAD B-TITE SCREW	3x8-8 MFC2	
2-1-25	ED330066	BIND HEAD SCREW	3x6 FCRM3-BL	
2-1-26	EP600190	BIND HEAD B-TITE SCREW	3x8 ZMC2-BL	
2-1-27	VG893800	BIND HEAD P-TITE SCREW	2x6 ZMC2-BL	
2-1-28	VE529700	PW HEAD B-TITE SCREW	3x6-8 MFC2-BL	
* 2-2	V6601000	P.C.B. ASS'Y	OPERATION	UCRATL
* 2-2	V6601100	P.C.B. ASS'Y	OPERATION	G
2-8	MF114250	FLEXIBLE FLAT CABLE C&C	14P 250mm	

\* New Parts

Ref. No.	PART NO.	Description	Remarks	Markets
* 2-11	V6065700	SUB CHASSIS		
* 2-12	V6065500	SUPPORT/PJ		
* 2-13	V6069000	BUTTON CASE ASSY	UPPER	GD
* 2-13	V6068900	BUTTON CASE ASSY	UPPER	BL
* 2-14	V6069200	BUTTON/POWER		GD
* 2-14	V6069100	BUTTON/POWER		BL
* 2-18	V6065600	SUPPORT/ENC		
* 2-19	V6071000	SUPPORT	SHAFT	
2-21	EP600190	BIND HEAD B-TITE SCREW	3x8 ZMC2-BL	
2-22	EP600130	BIND HEAD B-TITE SCREW	3x6 ZMC2-Y	
2-23	VN413300	BIND HEAD BONDING B-T. SCREW	3x8 MFZN2-BL	
4-1	V3316600	DC BRUSHLESS FAN	2410ML-05W-B40-T14	
4-2	VV691100	FRAME	SF	
4-4	VV713600	BRACKET	F	BL
4-6	VZ012900	CUSHION, FAN		
4-8	CB502030	BINDING TIE	S-75B	
4-10	EP630220	BIND HEAD P-TITE SCREW	3x8 ZMC2-BL	
4-12	VV220300	BIND HEAD B-TITE SCREW	3x30 MFZN2-BL	
* 5-1	V6228000	HEAT SINK	40BS300-L130	
△ 5-2	VY705000	TRANSISTOR	2SC5200 R,0	Q54, Q58, Q61, Q65
△ 5-3	V6063900	TRANSISTOR	2SC5358 O,R	Q68, Q72, Q75, Q79 Q82, Q86, Q89, Q93
5-5	VK196000	SHEET	22x29	
* 5-6	V6492000	RADIATION SHEET	BFG-20ADH-6 24X36	
5-7	VK195900	SHEET	19x24	
5-9	VK173200	SCREW, TRANSISTOR	3x15 SP FCM3	
5-13	VU195800	DAMPER, FIN		
* 11	V6600000	P.C.B. ASS'Y	DSP	UC
* 11	V6600100	P.C.B. ASS'Y	DSP	RLT
* 11	V6600200	P.C.B. ASS'Y	DSP	AG
* 12	V6602000	P.C.B. ASS'Y	F AMP	UC
* 12	V6602100	P.C.B. ASS'Y	F AMP	RT
* 12	V6602200	P.C.B. ASS'Y	F AMP	A
* 12	V6602300	P.C.B. ASS'Y	F AMP	G
* 12	V6602400	P.C.B. ASS'Y	F AMP	L
* 14	V6604000	P.C.B. ASS'Y	MAIN	UC
* 14	V6604100	P.C.B. ASS'Y	MAIN	RT
* 14	V6604200	P.C.B. ASS'Y	MAIN	A
* 14	V6604300	P.C.B. ASS'Y	MAIN	G
* 14	V6604400	P.C.B. ASS'Y	MAIN	L
* 15	V6605000	P.C.B. ASS'Y	FUNCTION	UC
* 15	V6605100	P.C.B. ASS'Y	FUNCTION	RT
* 15	V6605200	P.C.B. ASS'Y	FUNCTION	AL
* 15	V6605300	P.C.B. ASS'Y	FUNCTION	G
* 16	V6606000	P.C.B. ASS'Y	VIDEO	UCRT
* 16	V6606100	P.C.B. ASS'Y	VIDEO	AL
* 16	V6606200	P.C.B. ASS'Y	VIDEO	G
* 19	V6166300	AM/FM TUNER	TFCE1U213A U	UCRT
* 19	V6166400	AM/FM TUNER	TFCE1E213A G	AGL
△ 23	XZ441A00	POWER TRANSFORMER		U
△ 23	XZ442A00	POWER TRANSFORMER		C
△ 23	XZ444A00	POWER TRANSFORMER		A
△ 23	XZ445A00	POWER TRANSFORMER		GL

\* New Parts

Ref. No.	PART NO.	Description	Remarks	Markets
* 23	XZ443A00	POWER TRANSFORMER		RT
23-1	Vi449800	VOLTAGE SELECTOR	ESE-37284-F	RT
24	VP418300	POWER CORD ASS'Y		A
24	VZ542500	POWER CORD ASS'Y		RT
25	V2438700	CORD STOPPER	10P1	RAT
* 30	MF129100	FLEXIBLE FLAT CABLE	29P 100mm P=1.25	RAGTL
* 30	V6684000	S FLEXIBLE FLAT CABLE	29P 100mm P=1.25	UC
* 31	MF115180	FLEXIBLE FLAT CABLE	15P 180mm P=1.25	
32	MF112100	FLEXIBLE FLAT CABLE	12P 100mm P=1.25	
* 33	V6684100	S FLEXIBLE FLAT CABLE	15P 350mm P=1.25	
34	MF111400	FLEXIBLE FLAT CABLE	11P 400mm	
* 35	MF117140	FLEXIBLE FLAT CABLE	17P 140mm P=1.25	
* 36	MF115060	FLEXIBLE FLAT CABLE	15P 60mm P=1.25	
38	MF119200	FLEXIBLE FLAT CABLE	19P 200mm	
* 51	V6404800	TOP COVER		GD
51	VZ617400	TOP COVER		BL
52	VJ893400	BOTTOM COVER		
54	V2614300	FRAME	L	
* 55	V6063400	FRAME	R/LOWER	
56	V2614500	FRAME	SL	
57	VZ618100	FRAME	R/UP	
* 58	V6063300	FRAME, CENTER		
* 59	V6063500	REAR PANEL		RX-V3000 U
* 59	V6063700	REAR PANEL		RX-V3000 C
* 59	V6063800	REAR PANEL		RX-V3000 RT
* 59	V6064000	REAR PANEL		RX-V3000 A
* 59	V6064100	REAR PANEL		RX-V3000 L
* 59	V6064200	REAR PANEL		RX-V3000RDS G
60	VV826100	SUPPORT	TR	
* 61	V6064700	SHIELD CASE		
* 62	V6064900	SUPPORT	D/PCB	
* 63	V6669900	SSUPPORT, TOP		
* 64	V6068000	KNOB/D43		BL
* 64	V6068100	KNOB/D43		GD
* 65	V6001600	KNOB D15		BL
* 65	V6001700	KNOB D15		GD
* 66	V6069800	KNOB D15		BL
* 66	V6069900	KNOB D15		GD
* 67	V6078600	KNOB/D15		RX-V3000BL
* 67	V6078800	KNOB/D15		RX-V300GD
70	VJ895500	FRAME	A	
71	VT999700	SUPPORT	R/FR	
73	VE222600	CUSHION		
80	V0042500	LEG	D60xH21	GD
80	VS025000	LEG	D60xH21	
81	CB068880	PLASTIC RIVET	No. 1027	
82	CB605620	PLASTIC RIVET	No. 1781	
83	VV692400	SUPPORT	H/PCB	
* 84	V6064800	SUPPORT	SF	
85	VN413300	BIND HEAD BONDING B-T. SCREW	3x8 MFZN2-BL	
86	EP600190	BIND HEAD B-TITE SCREW	3x8 ZMC2-BL	
87	ED330066	BIND HEAD SCREW	3x6 FCRM3-BL	RT
88	EK930010	PW HEAD B-TITE SCREW	3x8-8 FCRM3-BL	

\* New Parts

Ref. No.	PART NO.	Description	Remarks	Markets
89	VK625000	CUP S-TITE SCREW	5x10-12 ZMC2-Y	
90	EK365090	PW HEAD S-TITE SCREW	4x8-10 FCRM3-BL	BL
90	VD069600	PW HEAD S-TITE SCREW	4x8-10 MFNI-33	GD
91	AA627310	GROUND TERMINAL		
92	EV265560	PLAIN WASHER	3.6x10x0.8 FNM3-3G	
93	EP600220	BIND HEAD B-TITE SCREW	3x10 ZMC2-Y	
94	EX601850	SPECIAL SCREW S-TITE	4x8-10 FCRM3-BL	BL
94	VZ893000	DECORATED SCREW S-TIGHT	4x8-10 MFNI-33	GD
96	VY979800	SUPPORT, FAN COVER		
97	VY980000	SUPPORT	R	
98	VY980100	PLATE, FAN COVER		
99	VQ199500	DAMPER	TRANSF.	RAGT
100	VK173200	SCREW, TRANSISTOR	3x15 SP FCM3	
101	CB502030	BINDING TIE	S-75B	
102	V6983800	SPACER/T05		
103	VQ758300	CUSHION,L		
104	V6276700	CUSHION/F		
105	VB072700	FLAT HEAD S-TITE SCREW	3x8 ZMC2-BL	
121	VY731200	BONDING HEAD TAPPING SCREW	3x10 MFNI33	
123	VK697600	BIND HEAD B-TITE SCREW	3x10 SP ZMC2-Y	
124	EP600530	BIND HEAD S-TITE SCREW	3x8 ZMC2-BL	
135	EL300690	PW HEAD P-TITE SCREW	3x8-8 MFC2-BL	
151	V3768900	SCREW, LOCK	17L-003C41	
		ACCESSORIES		
* 200	V6283400	REMOTE CONTROL TRANSMITTER	RAV221	
* 200-1	AAX20900	BATTERY COVER	103RRC-170-02R	
* 200-2	AAX20890	SLIDE COVER	103RRC-171-02R	
201	VQ307400	AM LOOP ANTENNA	81-653-645-110	
* 202	V6267000	ANTENNA, FM	1.4m	UCRT
202	VG850700	ANTENNA, FM	1.4m	AGL
* 203	V6545800	POWER CORD ASS'Y	INLET 2.0m	UC
* 203	V6545900	POWER CORD ASS'Y	INLET 2.0m	GL
* 204	V6181600	SHEET/SIDE R	1pc	BL
* 204	V6181800	SHEET/SIDE R	1pc	GD
* 205	V6181900	SHEET/SIDE L	1pc	BL
* 205	V6182100	SHEET/SIDE L	1pc	GD
		BATTERY(ALKALINE DRY)	1.5V LR6(3S)AG	

\* New Parts

# Parts List for Carbon Resistors

Value	1/4W Type Part No.	1/6W Type Part No.	Value	1/4W Type Part No.	1/6W Type Part No.
1.0 Ω	HJ35 3100	HF85 3100	10 kΩ	HF45 7100	HF45 7100
1.8 Ω	HJ35 3180	*	11 kΩ	HF45 7110	HF45 7110
2.2 Ω	HJ35 3220	HF85 3220	12 kΩ	HJ35 7120	HF85 7120
3.3 Ω	HJ35 3330	HF85 3330	13 kΩ	HF45 7130	HF45 7130
4.7 Ω	HJ35 3470	HF85 3470	15 kΩ	HF45 7150	HF45 7150
5.6 Ω	HJ35 3560	HF85 3560	18 kΩ	HF45 7180	HF45 7180
10 Ω	HF45 4100	HF45 4100	22 kΩ	HF45 7220	HF45 7220
15 Ω	HJ35 4150	HF85 4150	24 kΩ	HF45 7240	HF45 7240
22 Ω	HF45 4220	HF45 4220	27 kΩ	HJ35 7270	HF85 7270
27 Ω	HJ35 4270	HF85 4270	30 kΩ	HF45 7300	HF45 7300
33 Ω	HF45 4330	HF45 4330	33 kΩ	HF45 7330	HF45 7330
39 Ω	HJ35 4470	HF85 4390	36 kΩ	HF45 7360	HF45 7360
47 Ω	HF45 4470	HF45 4470	39 kΩ	HF45 7390	HF45 7390
56 Ω	HF45 4560	HF45 4560	47 kΩ	HF45 7470	HF45 7470
68 Ω	HF45 4680	HF45 4680	51 kΩ	HF45 7510	HF45 7510
75 Ω	HF45 4750	HF45 4750	56 kΩ	HF45 7560	HF45 7560
82 Ω	HF45 4820	HF45 4820	62 kΩ	HF45 7620	HF45 7620
91 Ω	HF45 4910	HF45 4910	68 kΩ	HF45 7680	HF45 7680
100 Ω	HF45 5100	HF45 5100	82 kΩ	HF45 7820	HF45 7820
110 Ω	HJ35 5110	HF85 5110	91 kΩ	HF45 7910	HF45 7910
120 Ω	HF45 5120	HF45 5120	100 kΩ	HF45 8100	HF45 8100
150 Ω	HF45 5150	HF45 5150	110 kΩ	HF45 8110	HF45 8110
160 Ω	HJ35 5160	*	120 kΩ	HF45 8120	HF45 8120
180 Ω	HF45 5180	HF45 5180	150 kΩ	HF45 8150	HF45 8150
200 Ω	HF45 5200	HF45 5200	180 kΩ	HF45 8180	HF45 8180
220 Ω	HF45 5220	HF45 5220	220 kΩ	HJ35 8220	HF85 8220
270 Ω	HF45 5270	HF45 5270	270 kΩ	HF45 8270	HF45 8270
330 Ω	HF45 5330	HF45 5330	300 kΩ	HF45 8300	HF45 8300
390 Ω	HF45 5390	HF45 5390	330 kΩ	HF45 8330	HF45 8330
430 Ω	HF45 5430	HF45 5430	390 kΩ	HJ35 8390	HF85 8390
470 Ω	HF45 5470	HF45 5470	470 kΩ	HF45 8470	HF45 8470
510 Ω	HF45 5510	HF45 5510	560 kΩ	HJ35 8560	HF85 8560
560 Ω	HF45 5560	HF45 5560	680 kΩ	HJ35 8680	HF85 8680
680 Ω	HF45 5680	HF45 5680	820 kΩ	HJ35 8820	HF85 8820
820 Ω	HF45 5820	HF45 5820	1.0 MΩ	HF45 9100	HF45 9100
910 Ω	HF45 5910	HF45 5910	1.2 MΩ	HJ35 9120	*
1.0 kΩ	HF45 6100	HF45 6100	1.5 MΩ	HJ35 9150	HF85 9150
1.2 kΩ	HF45 6120	HF45 6120	1.8 MΩ	HJ35 9180	HF85 9180
1.5 kΩ	HF45 6150	HF45 6150	2.2 MΩ	HJ35 9220	HF85 9220
1.8 kΩ	HF45 6180	HF45 6180	3.3 MΩ	HJ35 9330	HF85 9330
2.0 kΩ	HJ35 6200	HF85 6200	3.9 MΩ	HJ35 9390	*
2.2 kΩ	HF45 6220	HF45 6220	4.7 MΩ	HJ35 9470	HF85 9470
2.4 kΩ	HJ35 6240	HF85 6240			
2.7 kΩ	HF45 6270	HF45 6270			
3.0 kΩ	HF45 6300	HF45 6300			
3.3 kΩ	HF45 6330	HF45 6330			
3.6 kΩ	HJ35 6360	HF85 6360			
3.9 kΩ	HF45 6390	HF45 6390			
4.7 kΩ	HF45 6470	HF45 6470			
5.1 kΩ	HF45 6510	HF45 6510			
5.6 kΩ	HF45 6560	HF45 6560			
6.8 kΩ	HF45 6680	HF45 6680			
8.2 kΩ	HF45 6820	HF45 6820			
9.1 kΩ	HF45 6910	HF45 6910			

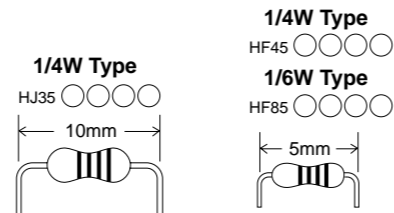

# RX-V3000/RX-V3000RDS

# YAMAHA